

Talking business can be a pleasure.

CHAMPAGNE
SPORTS
RESORT

CENTRAL DRAKENSBURG

WELCOME





Conference



Theme Evenings



Accommodation



Golf & Leisure



Wellness Centre



CONTENTS

White Pages

Price Structure

Golfing Green Fees & Rates

Other Activities

Salon Treatments

Menus



BUTTRESS

U-SHAPE	200 delegates	Length: 39.24 m
SCHOOLROOM	1200 delegates	Width: 30.83 m
CINEMA	1400 delegates	Height: 4.42 m (under beam)
BANQUET	950 delegates	6.42 m (centre under beam)

SENTINEL

U-SHAPE	160 delegates	Length: 40.34 m
SCHOOLROOM	720 delegates	Width: 22.32 m
CINEMA	1000 delegates	Height: 4.36 m (on the sides)
BANQUET	660 delegates	going to stage depth of 4.865 m

MONKS COWL

U-SHAPE	90 delegates	Length: 27.72 m
DOUBLE U-SHAPE	140 delegates	Width: 16.45 m
SCHOOLROOM	350 delegates	Height: 3.415 m (on the sides)
HERRINGBONE	200 delegates	Stage: 7.91 m wide in front,
CINEMA	500 delegates	2.80 m wide at the back,
BANQUET	300 delegates	and 2.53 m deep

SUMMIT

U-SHAPE	84 delegates	Length: 27.36 m
DOUBLE U-SHAPE	140 delegates	Width: 15.49 m
SCHOOLROOM	300 delegates	Height: 3.47 m
CINEMA	435 delegates	(on the sides)
BANQUET	260 delegates	Stage: 7.90 m
		wide in front,
		2.80 m wide at the back, and 2.5 m deep

ONDINI

U-SHAPE	48 delegates	Length: 14.76 m
DOUBLE U-SHAPE	65 delegates	Width: 12.01 m
HERRINGBONE	100 delegates	Height: 3.20 m
SCHOOLROOM	130 delegates	
CINEMA	200 delegates	
BANQUET	No Banqueting	

ZUNCKELS

U-SHAPE	60 delegates	Length: 21.68 m
SCHOOLROOM	140 delegates	Width: 8.2 m
CINEMA	200 delegates	Height: 3.44 m
BANQUET	120 delegates	
COCKTAIL PARTY	120 delegates	

TURRET

U-SHAPE	48 delegates	Length: 18.37 m
SCHOOLROOM	90 delegates	Width: 6.95 m
CINEMA	130 delegates	Height: 3.2 m
BANQUET	80 delegates	

INJASUTI

U-SHAPE	24 delegates	Length: 9.40 m
SCHOOLROOM	45 delegates	Width: 8.21 m
CINEMA	60 delegates	Height: 3.58 m
BANQUET	50 delegates	

ITHABA

U-SHAPE	45 delegates	Length: 18.65 m
SCHOOLROOM	70 delegates	Width: 5.48 m
CINEMA	110 delegates	Height: 3.9 m at the
BANQUET	60 delegates	highest point

STERKHORN

U-SHAPE	18 delegates	Length: 7.34 m
SCHOOLROOM	30 delegates	Width: 6.27 m
CINEMA	50 delegates	Height: 2.65 m at the
BANQUET	30 delegates	highest point

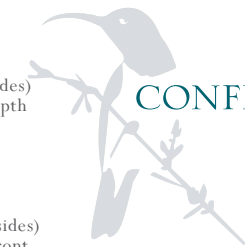

CONFERENCE

at a glance

AMPHLETT

U-SHAPE	42 delegates	Length: 16.23 m
SCHOOLROOM	78 delegates	Width: 6.99 m
CINEMA	105 delegates	Height: 2.50 m
BANQUET	No Banqueting	

GREYS PASS

U-SHAPE	18 delegates	Length: 6.87 m
SCHOOLROOM	20 delegates	Width: 3.63 m
CINEMA	20 delegates	Height: 3 m

DRAGONS BACK

U-SHAPE	18 delegates	Length: 6.87 m
SCHOOLROOM	20 delegates	Width: 3.63 m
CINEMA	20 delegates	Height: 3 m

EASTMANS

U-SHAPE	18 delegates	Length: 6.87 m
SCHOOLROOM	20 delegates	Width: 3.65 m
CINEMA	20 delegates	Height: 3 m

SHIPS PROW

U-SHAPE	18 delegates	Length: 6.87 m
SCHOOLROOM	20 delegates	Width: 3.65 m
CINEMA	20 delegates	Height: 3 m

CATHKIN ARMS BAR EXTENSION

U-SHAPE	48 delegates	Length: 18.16 m
SCHOOLROOM	60 delegates	Width: 5.45 m
CINEMA	125 delegates	
BANQUET	No Banqueting	

INFORMAL LOUNGE

FEATURE	Fireplace
Size	95 m ²

FORMAL LOUNGE

FEATURE	Fireplace
Size	167 m ²

Combined: 262 m²



AV equipment in conference venues at Champagne Sports Resort

MONKS COWL and SENTINEL

- Proxima Data/Video Projector – ceiling mounted
- True XGA (1024 x 768 supports VGA, SVGA, XGA and SXGA)
- Compatible with SUN, SGI, IBM, DEC and X-terminals
- Ultrabright 1900 lumens
- 2 computer inputs
- 2 video inputs (1 permanently connected to a VCR)
- 1 S-video
- Audio for PC through the system
- Live television as standard

Crestron Control System

All equipment is controlled via the Crestron touch panel; the touch panel is linked to the system via radio control and can be positioned anywhere in the room allowing the presenter control of:

- Lighting levels (four tracks incandescent with a single fluorescent track); lighting scenes are preset but can be adjusted if required
- Audio levels
- VCR functions
- CD/tape functions
- Microphone levels
- Proxima projector functions
- Projection screen up/down

Audio system

The room is equipped with 100 volt line ceiling mounted speakers offering uniform sound levels throughout the room. It is possible to connect auxiliary line-level inputs to the system which can be controlled manually. The system is equipped with Shure VHF radio microphones (1 lapel and 1 roaming) as well as an extra wired vocal microphone. Feedback is reduced via the integrated feedback eliminator.

Projection screen

Monks Cowl, Sentinel and Summit are equipped with a large 3 m x 2 m centrally mounted motorised projection screen.

ONDINI, ZUNCKELS and TURRET

- Proxima data/video projector – ceiling mounted
- True SVGA (800 x 600 supports VGA, SVGA, XGA)
- Compatible with SUN, SGI, IBM, DEC and X-terminals
- 700 lumens
- 2 computer inputs
- 2 video inputs (1 permanently connected to a VCR)
- 1 S-video
- Audio for PC through the system
- Live television as standard

Audio System

The room is equipped with 100 volt line ceiling mounted speakers offering uniform sound levels throughout the room.

It is possible to connect auxiliary line-level inputs to the system which can be controlled manually. The system is equipped with a radio lapel microphone and a roving microphone.

Projection screen

Large pull-down screen size 2.7 x 2.1 m

INJASUTI

- Overhead projector and screen
- Standard equipment i.e. flip chart, pens and/or whiteboard

Wireless systems in various hot spots around the resort

3-phase power in all large venues (Buttress, Summit, Monks Cowl, Ondini and Sentinel)

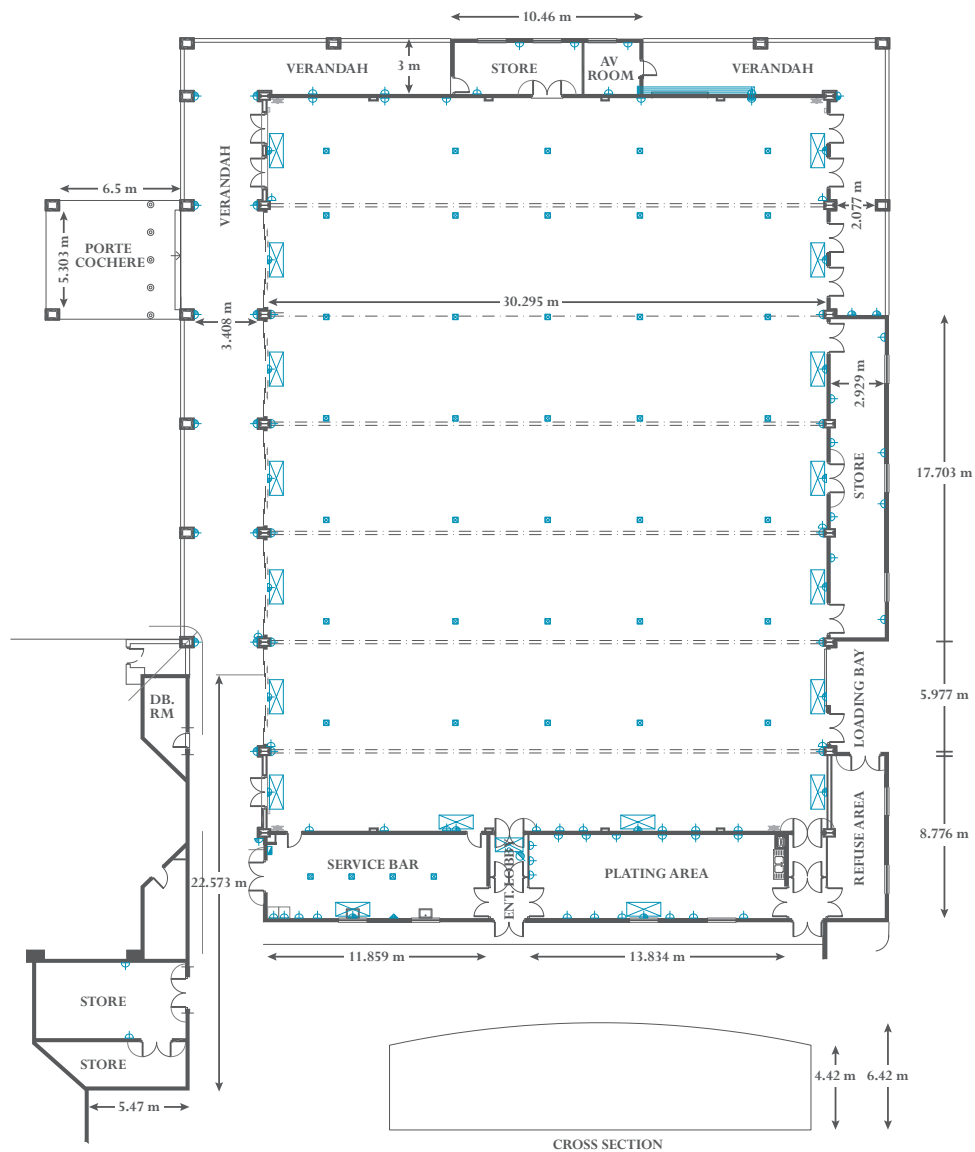

- | | |
|-------------------------------------|-----------------------------|
| Standard single 15amp plug point | Speaker volume control |
| Standard double 15amp plug point | Wall mounted aircon control |
| Floor box with 2x 15amp plug points | Light switch |
| 3-phase point | TV antenna jack |
| Wall mounted light fitting | Telephone jack |
| Wall mounted speaker | Audio-visual box |
| Audio-visual point | Distribution board |
| Wall-mounted screen | Aircon unit |
| Ceiling mounted projector | Internet server |
| Data point | Chandelier |
| Water supply point | |



CONFERENCE VENUE: BUTTRISS

A large thatched conference room. Acoustically designed and beautifully decorated to suit larger conference and exhibitions.

U-SHAPE	200 delegates
SCHOOLROOM	1200 delegates
CINEMA	1400 delegates
BANQUET	950 delegate



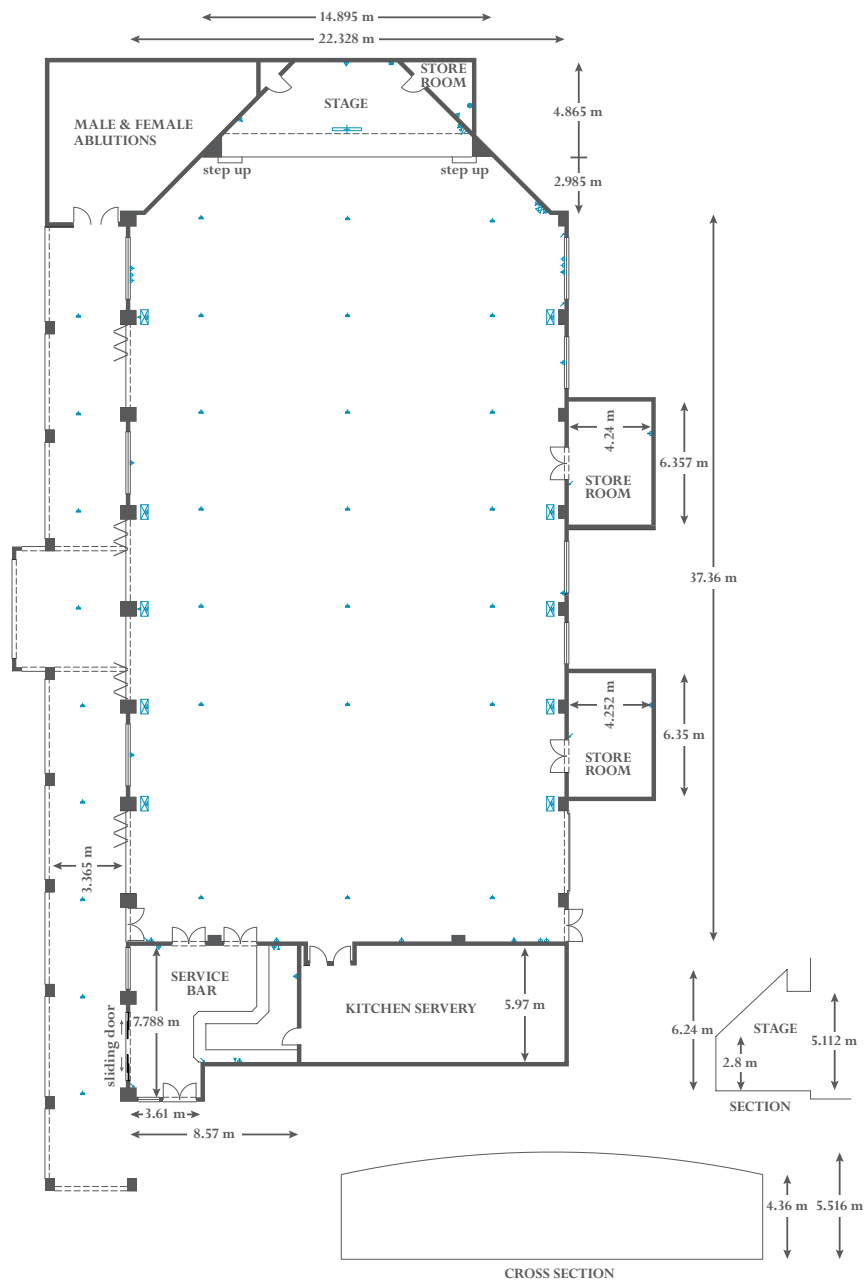

CONFERENCE VENUE: THE SENTINEL

A large thatched conference room facing the peaks of Champagne Castle and Cathkin Peak. Acoustically designed and beautifully decorated to suit larger conferences.

U-SHAPE	160 delegates
SCHOOLROOM	720 delegates
CINEMA	1000 delegates
BANQUET	660 delegates



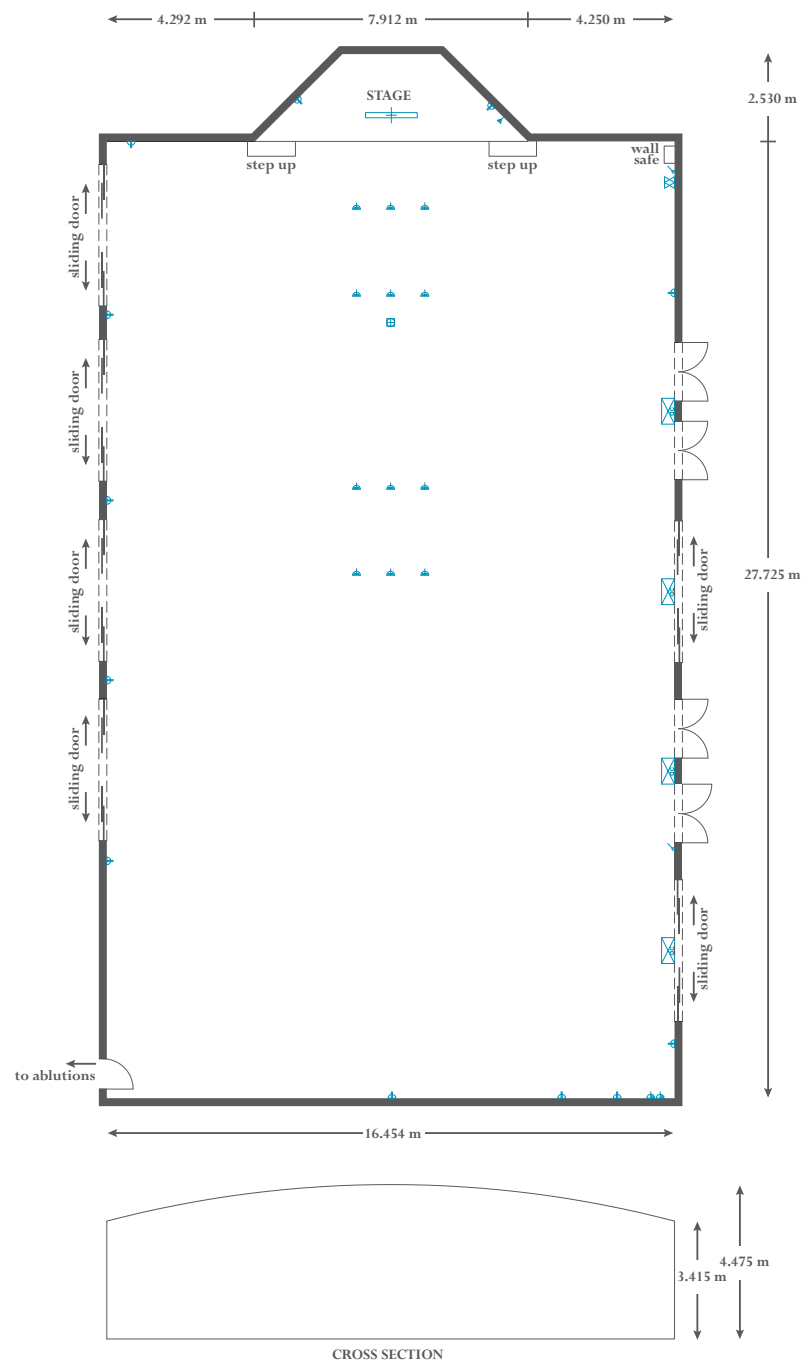

Please refer to Buttress for the key.



CONFERENCE VENUE: MONKS COWL

A large thatch conference room, acoustically designed and beautifully decorated to suit larger conferences. Fitted with state of the art conferencing equipment.

U-SHAPE	90 delegates
DOUBLE U-SHAPE	140 delegates
SCHOOLROOM	350 delegates
HERRINGBONE	200 delegates
CINEMA	500 delegates
BANQUET	300 delegates



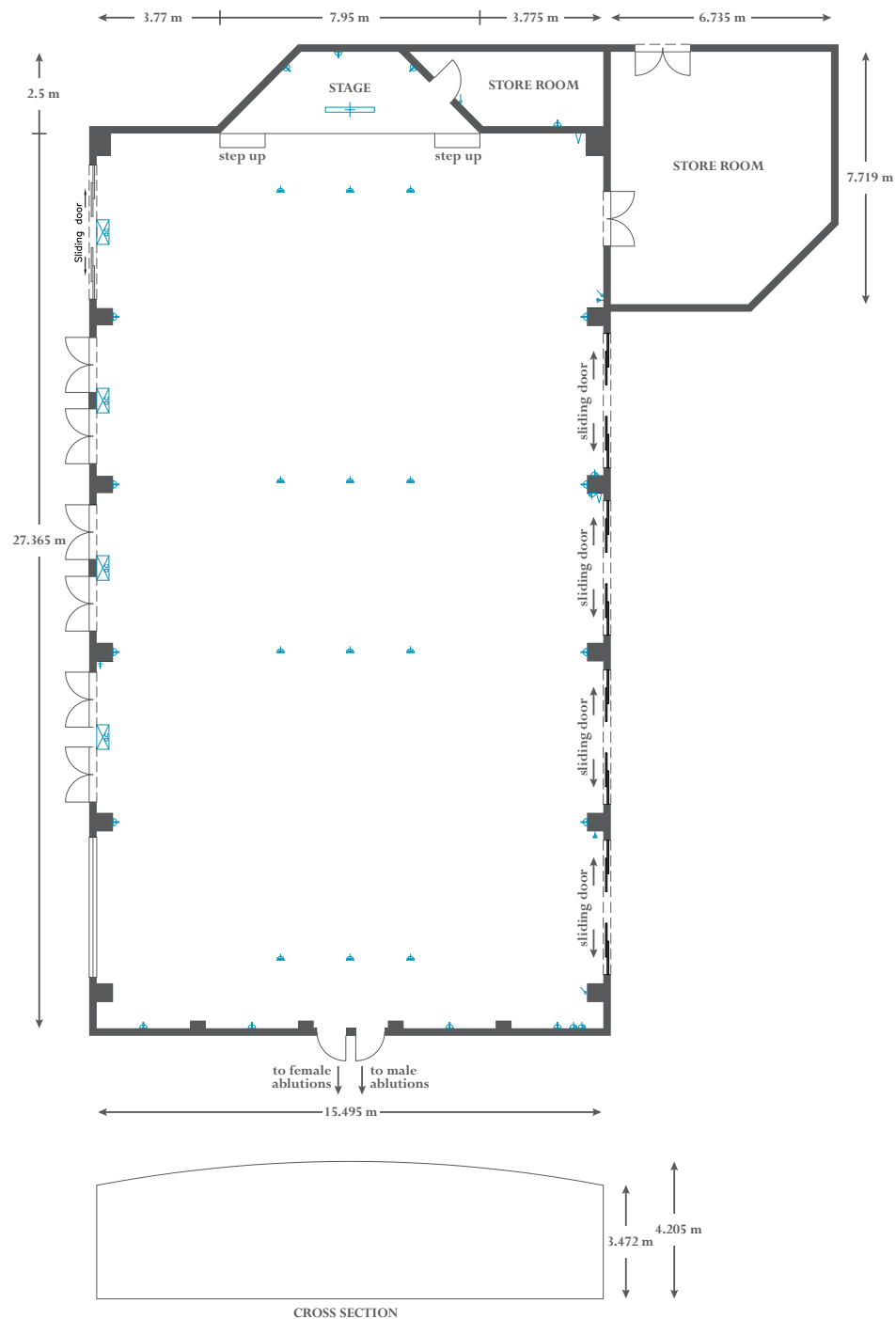

Please refer to Buttress for the key.



CONFERENCE VENUE: SUMMIT ROOM

Positioned parallel to the Monks Cowl room, this enables these two venues to be utilised as one venue via folding sliding doors that separate the two rooms.

U-SHAPE	84 delegates
DOUBLE U-SHAPE	140 delegates
SCHOOLROOM	300 delegates
CINEMA	435 delegates
BANQUET	260 delegates



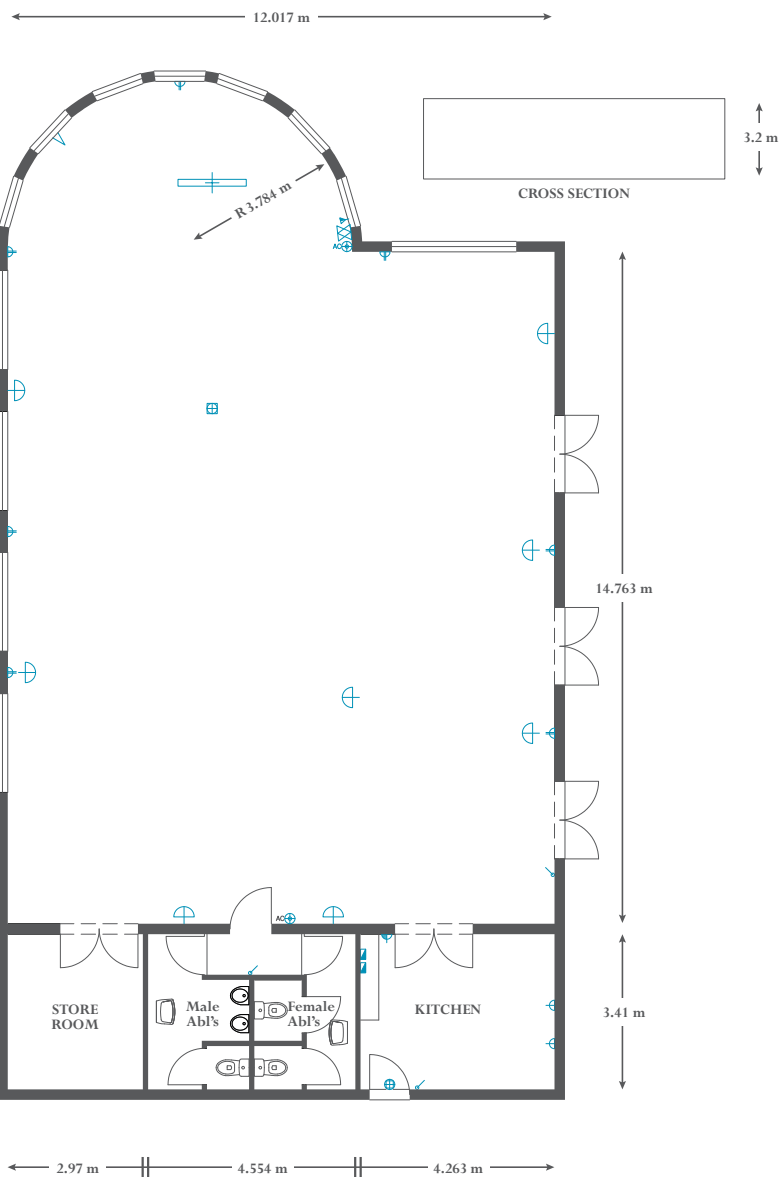

CONFERENCE VENUE: ONDINI

A large thatched freestanding conference room in an idyllic garden setting alongside the swimming pool. Beautifully decorated with the added attraction of an extended bay window feature and offering beautiful mountain views through charming cottage pane windows.

U-SHAPE	48 delegates
DOUBLE U-SHAPE	65 delegates
HERRINGBONE	100 delegates
SCHOOLROOM	130 delegates
CINEMA	200 delegates
BANQUET	No Banqueting



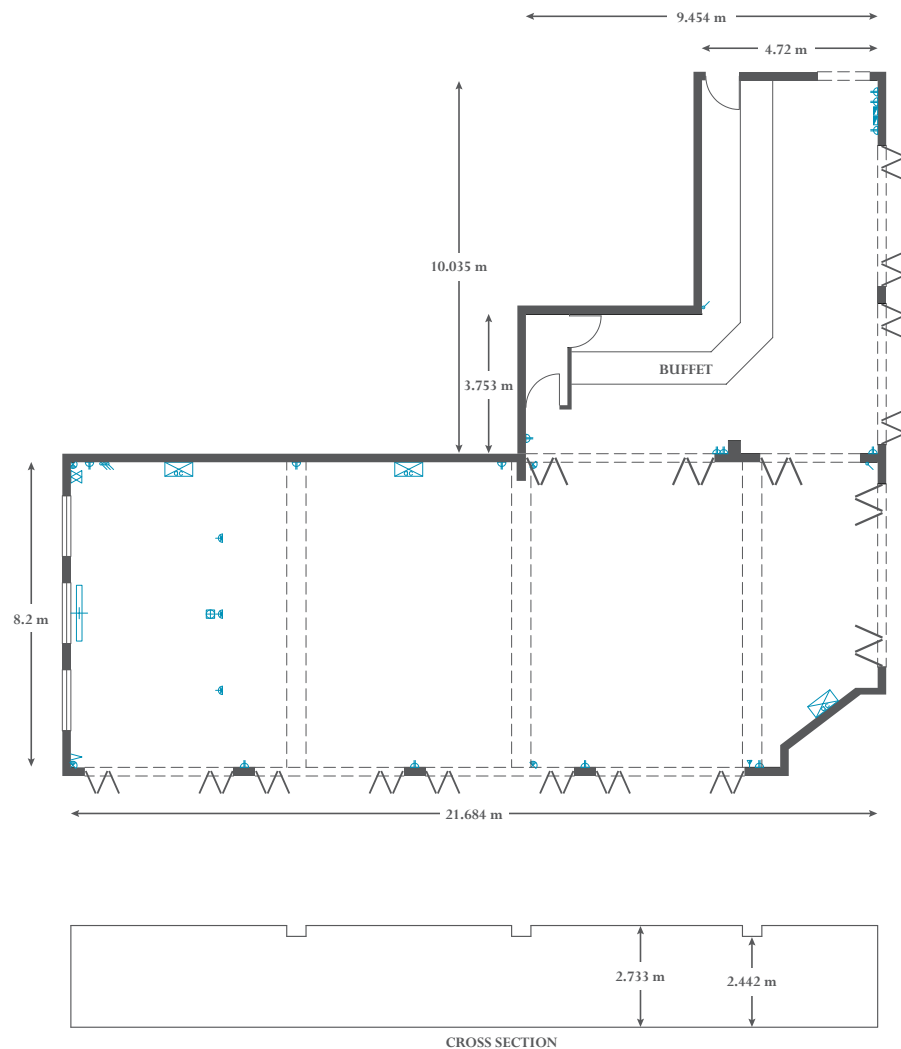

CONFERENCE VENUE: ZUNCLE'S

This venue can be serviced directly from a private dining extension buffet or maintain its simplicity as a private fully fitted room which transforms into either a fully functional business venue or a glittering function room for any occasion.

U-SHAPE	60 delegates
SCHOOLROOM	140 delegates
CINEMA	200 delegates
BANQUET	120 delegates
COCKTAIL PARTY	120 delegates



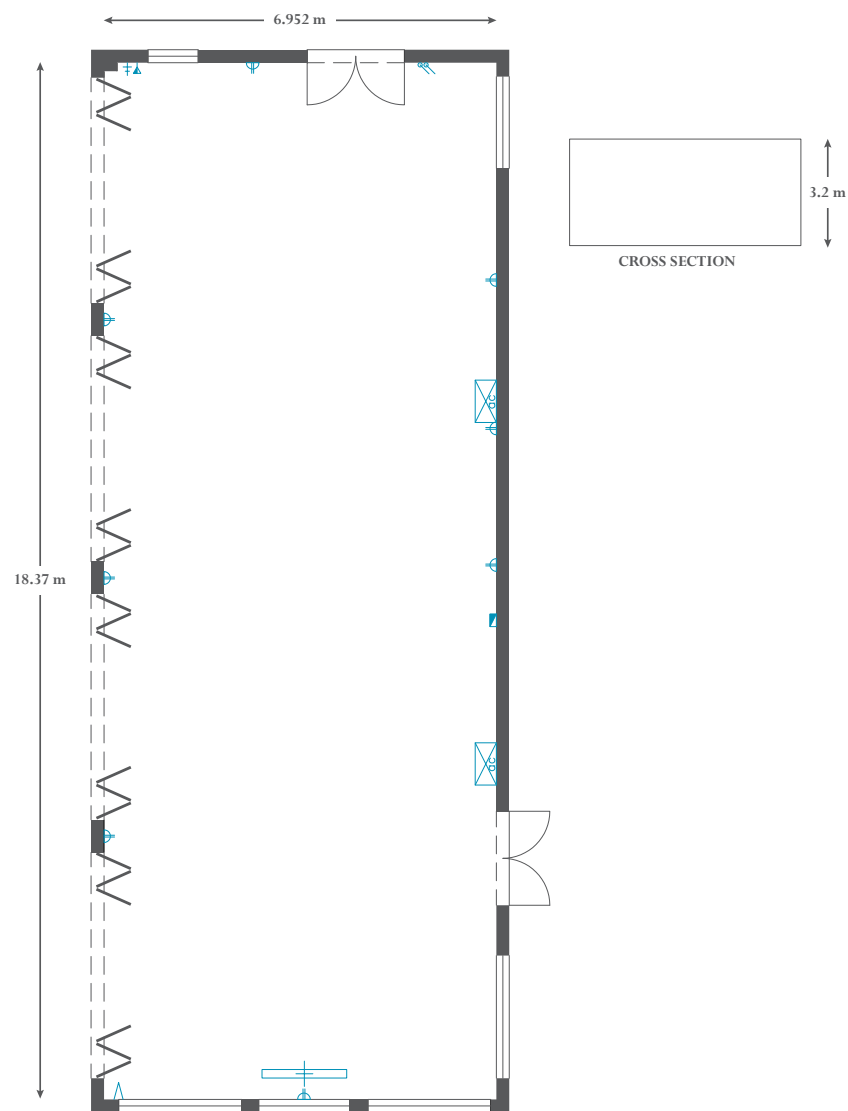

Please refer to Buttress for the key.



CONFERENCE VENUE: TURRET ROOM

The Turret Room is situated alongside the Zuncels Conference Room, and should the need arise, can be opened onto Zuncels through folding sliding doors. The Turret Room has two entrances with the second entrance accessible by vehicle for loading and unloading. This venue can also interlead to the Injasuti Room through a landscaped passageway.

U-SHAPE	48 delegates
SCHOOLROOM	90 delegates
CINEMA	130 delegates
BANQUET	80 delegates



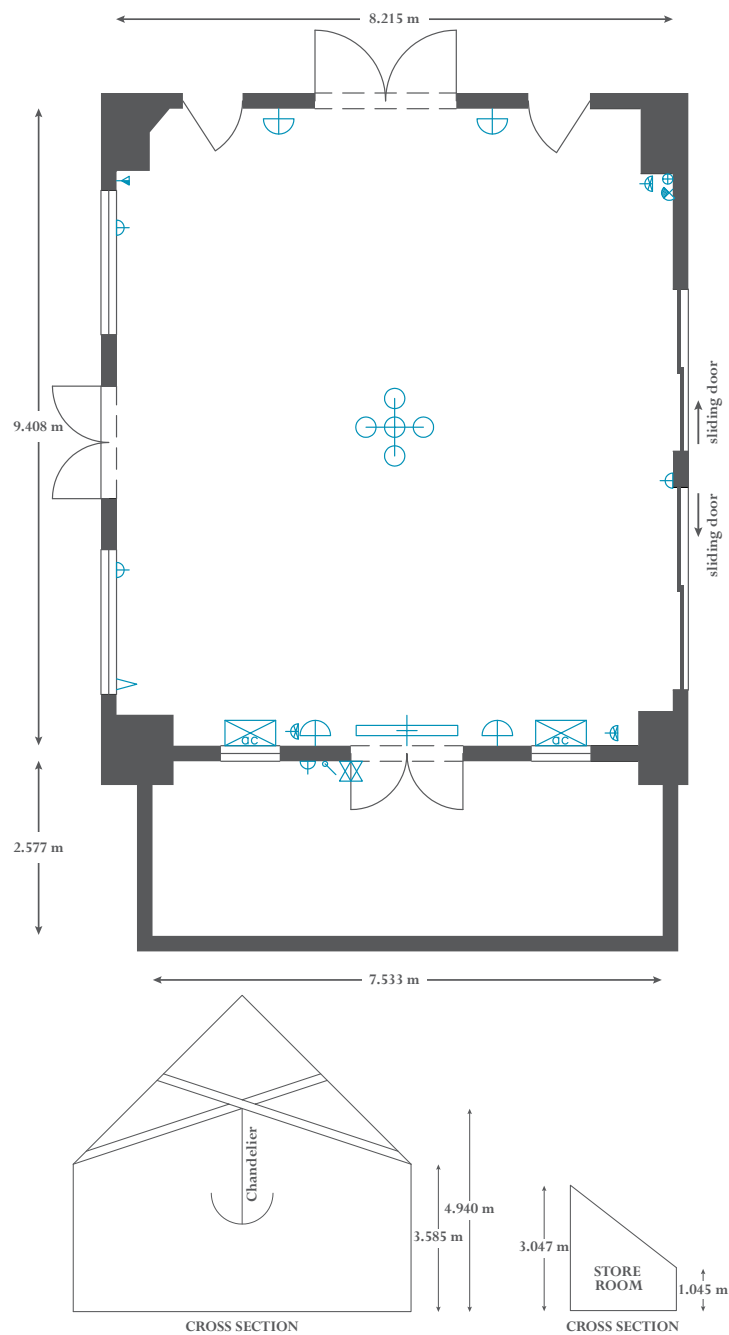

CONFERENCE VENUE: INJASUTI

A charming venue, with cottage pane windows, overlooking a garden. Ideal for smaller conferences or boardroom-style discussions.

U-SHAPE	24 delegates
SCHOOLROOM	45 delegates
CINEMA	60 delegates
BANQUET	50 delegates



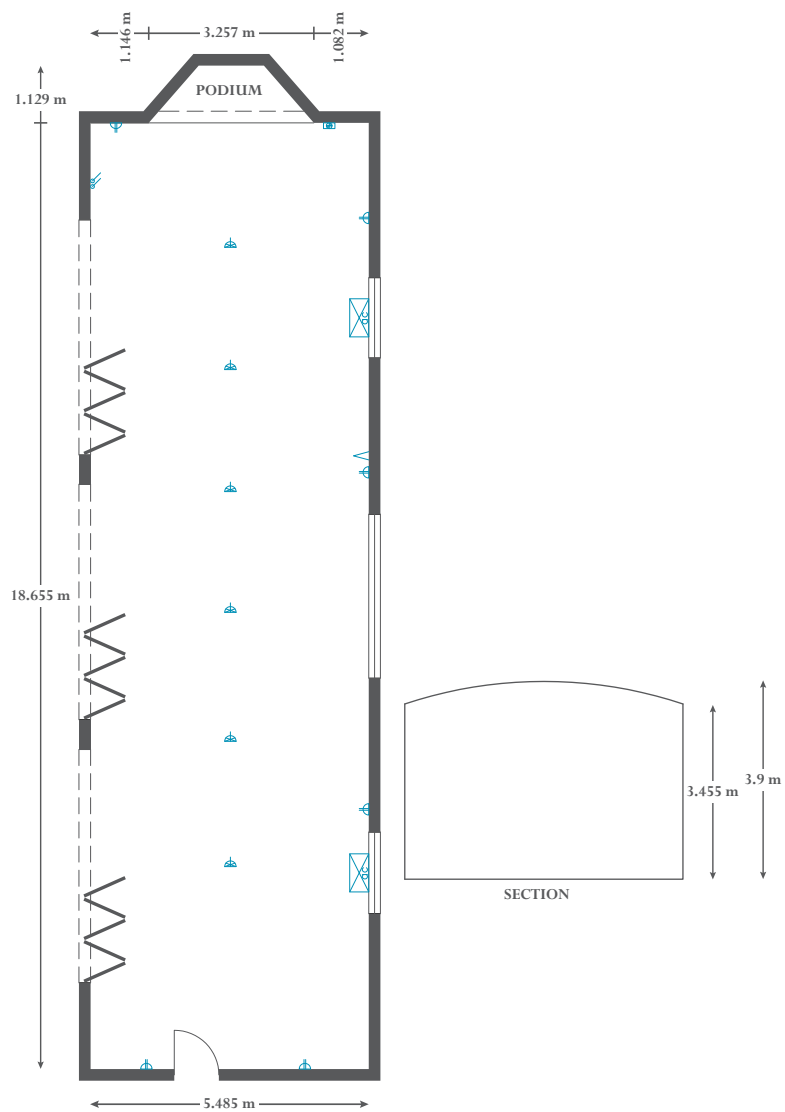

CONFERENCE VENUE: ITHABA

167 m² with natural light. Ideal as a break-away conference room, exhibition space, registration area or buffet room servicing the Monks Cowl, Summit rooms and El Mirador Lounge area.

U-SHAPE	45 delegates
SCHOOLROOM	70 delegates
CINEMA	110 delegates
BANQUET	60 delegates



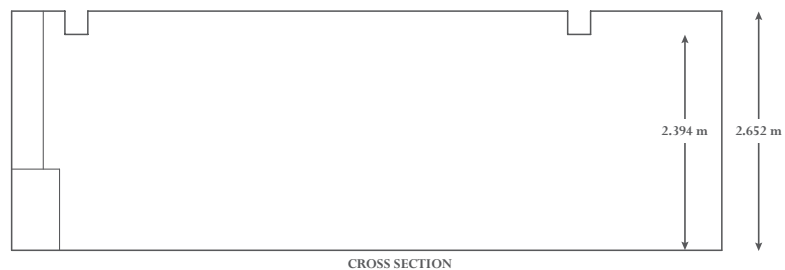
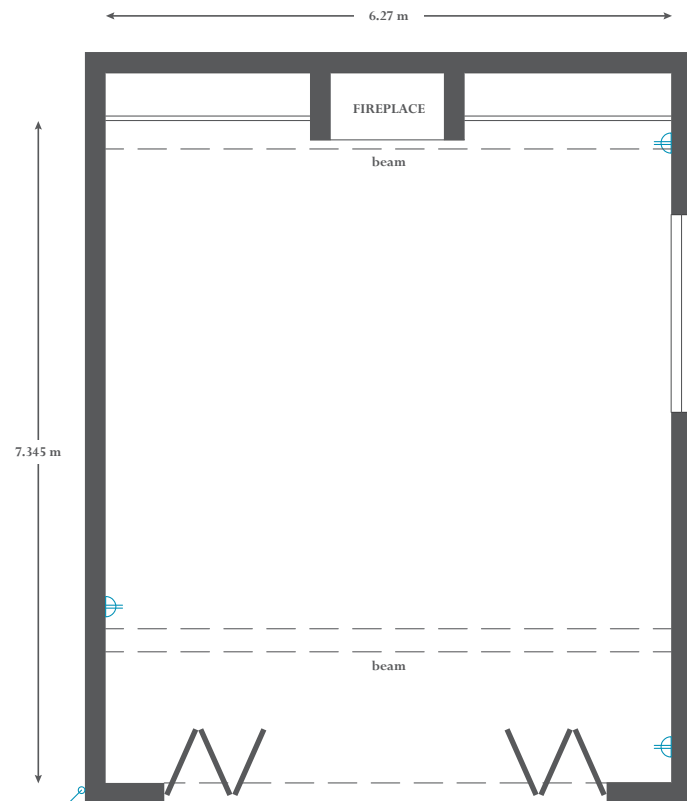

Please refer to Buttress for the key.



CONFERENCE VENUE: STERKHORN

This venue can be set up as either a conference room or a comfortable lounge environment for informal meetings.

U-SHAPE	18 delegates
SCHOOLROOM	30 delegates
CINEMA	50 delegates
BANQUET	30 delegates



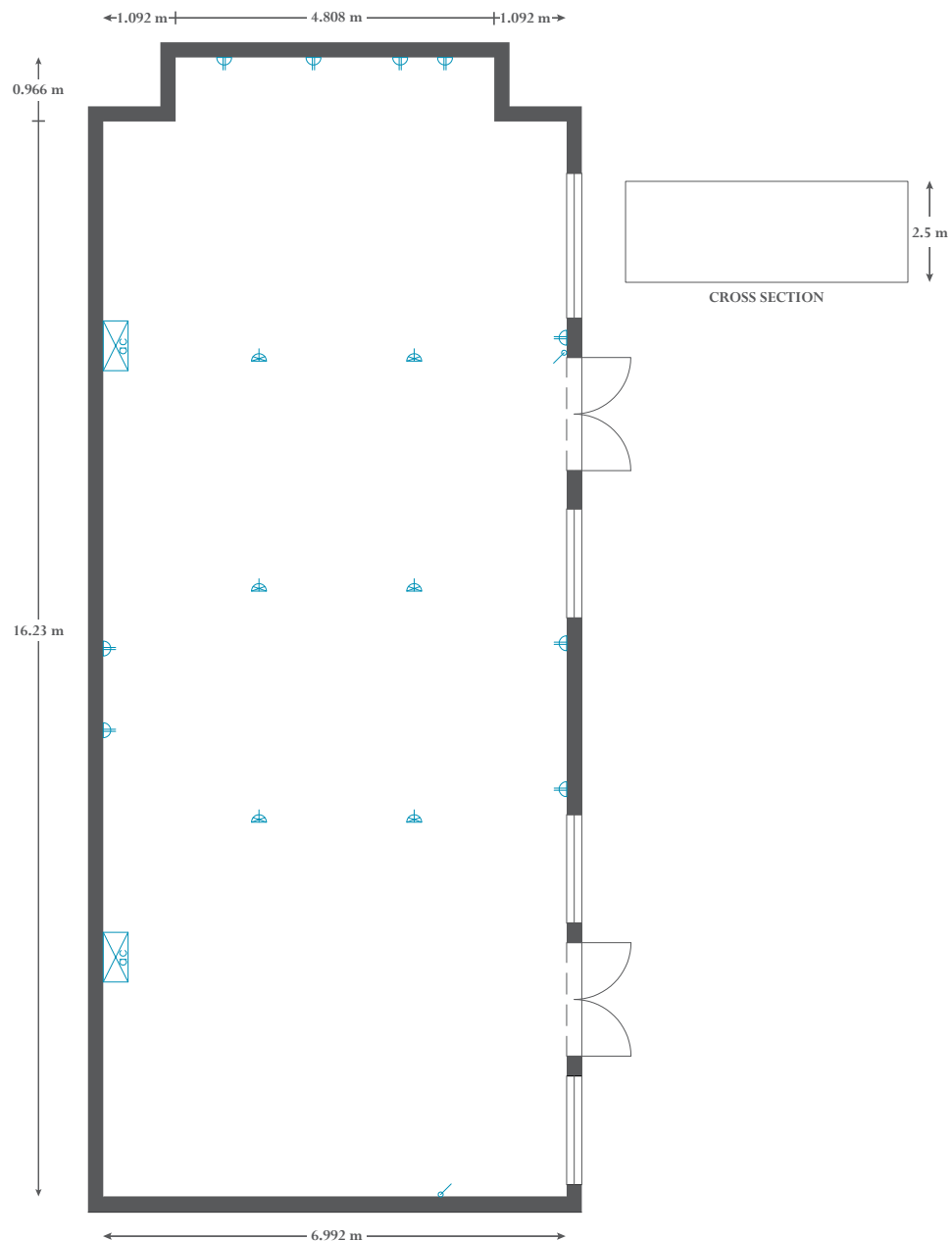

Please refer to Buttress for the key.



CONFERENCE VENUE: AMPHLETT ROOM

This private secluded and freestanding room opens onto a private hedged garden ideal for smaller conference groups.

U-SHAPE	42 delegates
SCHOOLROOM	78 delegates
CINEMA	105 delegates
BANQUET	No Banqueting





The four boardrooms are positioned adjacent to each other and located upstairs from the main reception foyer. They are equipped with 50-inch LCD wall mounted screens and flip charts. These private and intimate boardrooms are ideal for smaller groups and management and board meetings.

CONFERENCE VENUE: BOARDROOM GREYS PASS

U-SHAPE	18 delegates
SCHOOLROOM	20 delegates
CINEMA	20 delegates

CONFERENCE VENUE: BOARDROOM EASTMANS

U-SHAPE	18 delegates
SCHOOLROOM	20 delegates
CINEMA	20 delegates

CONFERENCE VENUE: BOARDROOM DRAGONS BACK

U-SHAPE	18 delegates
SCHOOLROOM	20 delegates
CINEMA	20 delegates

CONFERENCE VENUE: BOARDROOM SHIPS PROW

U-SHAPE	18 delegates
SCHOOLROOM	20 delegates
CINEMA	20 delegates





THEME EVENINGS

GALA DINNER

Champagne Sports Resort has a range of materials and colours with which to provide your basic colour selection and contrast detailing. We will work around your themed colour choice with a variety of materials such as taffeta, velvet, and organza to create the look and feel to suit your conference theme. Underplates and detailed serviettes add the personal touch to your settings.

FUN, THEMED EVENINGS

With trends changing continually, we will adapt our themed evenings to suit your conference theme. Themes that we have done successfully include:

AROUND THE WORLD: we decorate your tables according to the countries of your choice, to match the buffet or to go with the conference theme. England, Greece, Germany, South Africa, Italy, India and Mexico are our most popular.

CRYSTAL ICE: a winter-wonderland feel of white, silver and crystal with a hint of blue.

A NIGHT OF MAGIC: with magical backdrops and table décor to create a fun feeling of mystery.

SEVEN SEAS: we create the nautical feel with hues of blues and greens with nautical centre pieces. We can adapt to traditional blue and white with a touch of red.

FOUR ELEMENTS: with Air, Water, Earth and Fire, we divide the room into four and dress the tables according to each element.

SANDS OF TIME: an evening of calm and neutral colours to complement our surrounds. This theme goes well in all our venues and does not require draping.

MEXICAN FIESTA: for a party night that is easy for the delegates to dress up and join in. Bright and Loud.

AFRICAN AFFAIR: a theme that can be adapted to the traditional outdoors or the stunning sunsets of Africa.

WESTERN: with Cowboys and gingham, cattle and grass, we take you back to the Good 'ol Western days.

PUB EVENING: we have the UK Pub and the Irish Pub ... a chilled evening.

TROPICAL EVENING: bright colours, oversized faux flowers and leis for the delegates.

Draping of venues, ceiling décor, serviette detail, buffet décor and gifts for your guests can all be arranged through us.

Our décor is designed around your individual needs. Please contact us for a personalised quote.



All pricing on theme evenings is available from conference reservations at the resort on 036 468 8000.



The resort offers a variety of superb, serviced accommodation. All rooms are mountain facing fitted with the following: telephone, colour television (three regional channels, M-Net and Movie Magic, Disney and three sports channels), tea/coffee facilities, hairdryer, overhead ceiling fan and bathroom en-suite. Champagne Sports Resort does not offer room service.

HOTEL BEDROOMS:

- Mountain facing double room with 1 double bed (6 units)
- Mountain facing executive suite with 1 double bed (3 units) (bar stocked on request)
- Mountain facing family room with 1 double bed and 2 single beds (21 units)
- Mountain facing double/twin room with 2 single beds (118 units)
- Mountain facing presidential suite (4 units) 99m², luxury king bed. Bars stocked on request.

Total number of rooms: 152

Total number of beds (one person per double bed): 312 (excluding T/S Units)

Wheelchair ramps available

TIMESHARE UNITS:

Champagne Sports resort has 91 timeshare units. Each unit has a kitchen, dining room and living room area.

- 1 bedroom 1 bathroom units (2 units)
- 2 bedroom 2 bathroom units (28 units)
- 3 bedroom 2 bathroom units (3 units)
- 3 bedroom 3 bathroom units (58 units)

Total: 91

Timeshare chalets are available for larger groups once all hotel accommodation has been fully occupied. The décor of timeshare and hotel are of the same high standard.

Please note that check-in time is 14h00 and checkout is strictly 10h00 for the hotel. Chalets subject to availability.

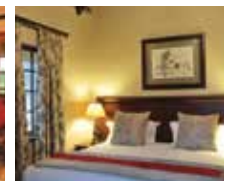



ACCOMMODATION





Hotel & Timeshare
GOLF & LEISURE

**Sporting and leisure facilities included
in rate, excluding equipment:**

5 tennis courts (2 of which are floodlit),
table tennis, volleyball, bowls, 5 swimming
pools; walks, trampolines, darts, pool tables,
basketball, sports-putt and children's play areas.



Champagne Sports Resort boasts a magnificent 18 hole Championship Golf Course nestled in the lush green valleys below the rugged peaks of the Central Drakensberg. Steadily climbing the rankings Champagne Sports Resort has been rated as South Africa's most beautiful golf course. Many years of thought, design and investment have resulted in this incredible final product that golfers travel far and wide to experience. There is something truly unique and special playing golf on one of the most scenic courses in the world with the awe-inspiring presence of the Champagne and Cathkin Peaks towering above you. It is an experience to behold and one we trust all of you will remember and return to enjoy.





Hotel & Timeshare
WELLNESS CENTRE

CHAMPAGNE SPORTS SALON:

Champagne Sports Resort is proud to announce completion of the new salon and gym. Our salon boasts a well balanced range of treatments and products to ensure you leave feeling revitalised and refreshed. Our broad range of treatments and incredible views from the resting area ensure a relaxing upmarket salon experience. The new gym is fully equipped to ensure training options to suit all requirements from general weight training to cardiovascular exercise.

Champagne Sports Salon: 072 611 1767
(all treatments can be viewed in the White Pages at the back of this pack)



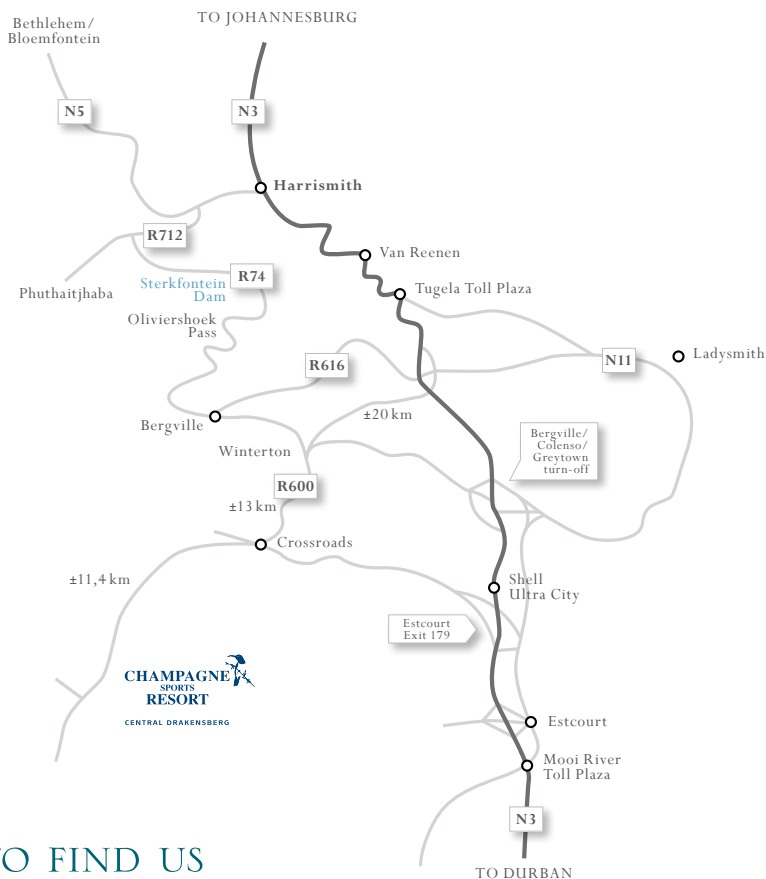

HOW TO FIND US



Freeway route from Durban:

Take N3 past Pietermaritzburg, through Mooi River and past the Wagendrift Dam (on your left). Take Exit 179 (ESTCOURT NORTH) and turn left at the glide-off. Travel 28kms through Loskop (beware of animals on this road) to the crossroads signposted R600 Central Drakensberg. Turn left and drive for ±11kms to Champagne Sports on your left.

Scenic route from Johannesburg, suitable ONLY if conditions are not wet or freezing:

Take N3 from Johannesburg to Harrismith then right onto N5 (BETHLEHEM/BLOEMFONTEIN). Turn left onto R712 (QWA-QWA/BERGVILLE) after ±5kms, then left again onto R74 (BERGVILLE/OLIVIERSHOEK PASS) after ±10kms. Pass Sterkfontein Dam, through Bergville towards Winterton. Once in Winterton, turn right at the crossroads signposted R600 Central Drakensberg (at the Engen garage). Continue ±13kms, over the Thokozisa crossroads, then for another ±11kms to Champagne Sports on your left. ±11kms to Champagne Sports on your left.

Freeway route from Johannesburg:

Take N3 from Johannesburg to Van Reenen's Pass, and through Tugela Plaza at the bottom of the Pass. Travel ±14kms to R616 (BERGVILLE) turn, then left onto N11 to Ladysmith. Drive for ±4kms before turning right onto R600 (SPIOENKOP/WINTERTON). Go over highway, past Spioenkop Lodge/Nature Reserve to T-junction. Turn left towards Winterton. Once in Winterton, turn right at the crossroads signposted R600 Central Drakensberg (at the Engen garage). Continue ±13kms, over the Thokozisa crossroads, then for another ±11kms to Champagne Sports on your left.