

Talking business can be a pleasure.

CHAMPAGNE
SPORTS
RESORT



CENTRAL DRAKENSBERG

WELCOME





Conference



Accommodation



Theme Evenings



Sporting & Leisure



Wellness Centre



CONTENTS

Insert Pages

Price Structure

Golfing Green Fees & Rates

Activities

Salon Rates

Menus



BUTTRESS

U-SHAPE	145 delegates	Length: 39.24 m
CLASSROOM	1042 delegates	Width: 30.83 m
THEATRE	1400 delegates	Height: 4.42 m (under beam)
BANQUET	900 delegates	6.42 m (centre under beam)

SENTINEL

U-SHAPE	120 delegates	Length: 40.34 m
CLASSROOM	645 delegates	Width: 22.32 m
THEATRE	1000 delegates	Height: 4.36 m (on the sides)
BANQUET	660 delegates	going to stage depth of 4.865 m

MONKS COWL

U-SHAPE	90 delegates	Length: 27.72 m
DOUBLE U-SHAPE	140 delegates	Width: 16.45 m
CLASSROOM	320 delegates	Height: 3.415 m, on the sides
HERRINGBONE	200 delegates	Stage: 7.91 m wide in front,
THEATRE	500 delegates	2.80m wide at the back,
BANQUET	300 delegates	and 2.53 m deep

SUMMIT

U-SHAPE	84 delegates	Length: 27.36 m
CLASSROOM	270 delegates	Width: 15.49 m
THEATRE	435 delegates	Height: 3.47 m, on the sides
BANQUET	260 delegates	Stage: 7.90 m wide in front,
		2.80 m wide at the back, and 2.5 m deep

ONDINI

U-SHAPE	48 delegates	Length: 14.76 m
DOUBLE U-SHAPE	65 delegates	Width: 12.01 m
HERRINGBONE	100 delegates	Height: 3.20 m
CLASSROOM	130 delegates	
THEATRE	200 delegates	
BANQUET	150 delegates	

ZUNCKELS

U-SHAPE	60 delegates	Length: 21.68 m
CLASSROOM	140 delegates	Width: 8.2 m
THEATRE	200 delegates	Height: 3.44 m
BANQUET	120 delegates	
COCKTAIL PARTY	120 delegates	

TURRET

U-SHAPE	48 delegates	Length: 18.37 m
CLASSROOM	90 delegates	Width: 6.95 m
THEATRE	130 delegates	Height: 3.2 m
BANQUET	80 delegates	

INJASUTI

U-SHAPE	24 delegates	Length: 9.40 m
CLASSROOM	45 delegates	Width: 8.21 m
THEATRE	60 delegates	Height: 3.58 m
BANQUET	50 delegates	

ITHABA

U-SHAPE	45 delegates	Length: 18.65 m
CLASSROOM	60 delegates	Width: 5.48 m
THEATRE	110 delegates	Height: 3.9 m at the highest point
BANQUET	60 delegates	

STERKHORN

U-SHAPE	18 delegates	Length: 7.34 m
CLASSROOM	24 delegates	Width: 6.27 m
THEATRE	50 delegates	Height: 2.65 m at the highest point
BANQUET	30 delegates	

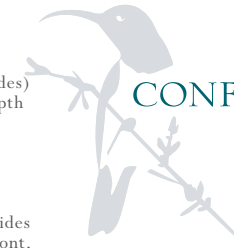

CONFERENCE

at a glance

AMPHLETT

U-SHAPE	42 delegates	Length: 16.23 m
CLASSROOM	78 delegates	Width: 6.99 m
THEATRE	105 delegates	Height: 2.50 m
BANQUET	60 delegates	

GREYS PASS

U-SHAPE	18 delegates	Length: 6.87 m
CLASSROOM	20 delegates	Width: 3.63 m
THEATRE	25 delegates	Height: 3 m
BANQUET	10 delegates	

DRAGONS BACK

U-SHAPE	18 delegates	Length: 6.87 m
CLASSROOM	20 delegates	Width: 3.63 m
THEATRE	25 delegates	Height: 3 m
BANQUET	10 delegates	

EASTMANS

U-SHAPE	18 delegates	Length: 6.87 m
CLASSROOM	20 delegates	Width: 3.65 m
THEATRE	25 delegates	Height: 3 m
BANQUET	10 delegates	

SHIPS PROW

U-SHAPE	18 delegates	Length: 6.87 m
CLASSROOM	20 delegates	Width: 3.65 m
THEATRE	25 delegates	Height: 3 m
BANQUET	10 delegates	

CATHKIN ARMS BAR EXTENSION

U-SHAPE	48 delegates	Length: 18.16 m
CLASSROOM	60 delegates	Width: 5.45 m
THEATRE	125 delegates	
BANQUET	60 delegates	

INFORMAL LOUNGE

FEATURE	Fireplace
Size	95 m ²

FORMAL LOUNGE

FEATURE	Fireplace
Size	167 m ²

Combined: 262 m²



AV equipment in conference venues at Champagne Sports Resort

MONKS COWL and SENTINEL

- Proxima Data/Video Projector – ceiling mounted
- True XGA (1024 x 768 supports VGA, SVGA, XGA and SXGA)
- Compatible with SUN, SGI, IBM, DEC and X-terminals
- Ultrabright 1900 lumens
- 2 computer inputs
- 2 video inputs (1 permanently connected to a VCR)
- 1 S-video
- Audio for PC through the system
- Live television as standard

Crestron Control System

All equipment is controlled via the Crestron touch panel.

The touch panel is linked to the system via radio control and can be positioned anywhere in the room allowing the presenter control of:

- Lighting levels (four tracks incandescent with a single fluorescent track). Lighting scenes are preset but can be adjusted if required.
- Audio levels
- VCR functions
- CD/tape functions
- Microphone levels
- Proxima projector functions
- Projection screen up/down

Audio system

The room is equipped with 100 volt line ceiling mounted speakers offering uniform sound levels throughout the room. It is possible to connect auxiliary line-level inputs to the system which can be controlled manually. The system is equipped with Shure VHF radio microphones (1 lapel and 1 roaming) as well as an extra wired vocal microphone. Feedback is reduced via the integrated feedback eliminator.

Projection screen

Monks Cowl, Sentinel and Summit are equipped with a large 3 m x 2 m centrally mounted motorised projection screen.

ONDINI, ZUNCKELS and TURRET

- Proxima data/video projector – ceiling mounted
- True SVGA (800 x 600 supports VGA, SVGA, XGA)
- Compatible with SUN, SGI, IBM, DEC and X-terminals
- 700 lumens
- 2 computer inputs
- 2 video inputs (1 permanently connected to a VCR)
- 1 S-video
- Audio for PC through the system
- Live television as standard

Audio System

The room is equipped with 100 volt line ceiling mounted speakers offering uniform sound levels throughout the room.

It is possible to connect auxiliary line-level inputs to the system which can be controlled manually. The system is equipped with a radio lapel microphone and a roving microphone.

Projection screen

Large pull-down screen size 2,7 x 2,1 m

INJASUTI

- Overhead projector and screen
- Standard equipment i.e. flip chart, pens and/or whiteboard

Wireless systems in various hot spots around the resort

3-phase power in all large venues (Buttress, Summit, Monks Cowl, Ondini and Sentinel)

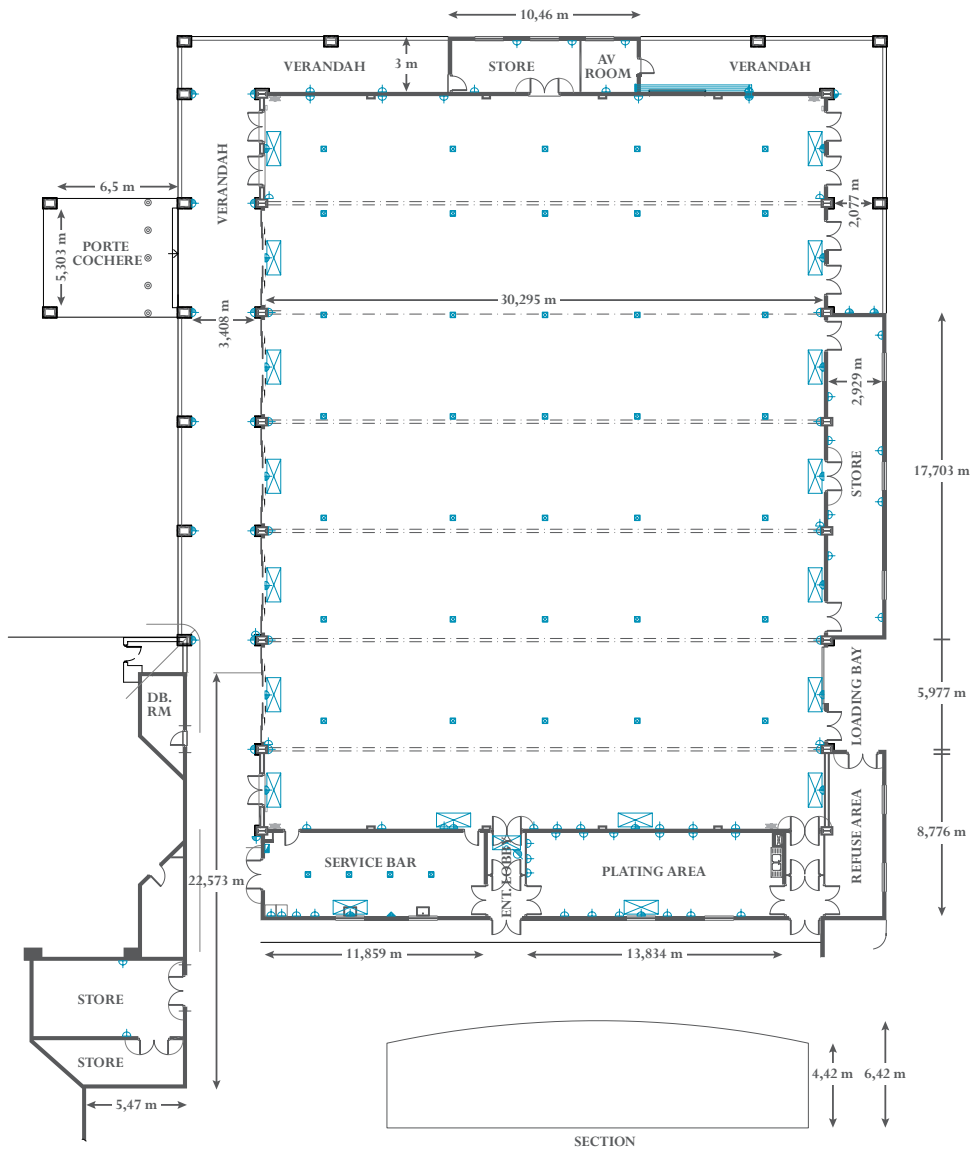

- | | | | |
|---|-------------------------------------|---|-----------------------------|
| ⚡ | Standard single 15amp plug point | 🔊 | Speaker volume control |
| ⚡ | Standard double 15amp plug point | 🔊 | Wall mounted aircon control |
| ⚡ | Floor box with 2x 15amp plug points | 🔌 | Light switch |
| ⚡ | 3-phase point | 📺 | TV antenna jack |
| 🔌 | Wall mounted light fitting | 📞 | Telephone jack |
| 🔊 | Wall mounted speaker | 📺 | Audio-visual box |
| 🔊 | Audio-visual point | 🔌 | Distribution board |
| 📺 | Wall-mounted screen | 🔌 | Aircon unit |
| 📺 | Ceiling mounted projector | 🌐 | Internet server |
| 📺 | Data point | 🏮 | Chandelier |
| 🚰 | Water supply point | | |



CONFERENCE VENUE: BUTTRISS

A large thatched conference room. Acoustically designed and beautifully decorated to suit the larger conference and exhibitions.

U-SHAPE	147 delegates
CLASSROOM	1042 delegates
THEATRE	1404 delegates
BANQUET	990 delegate



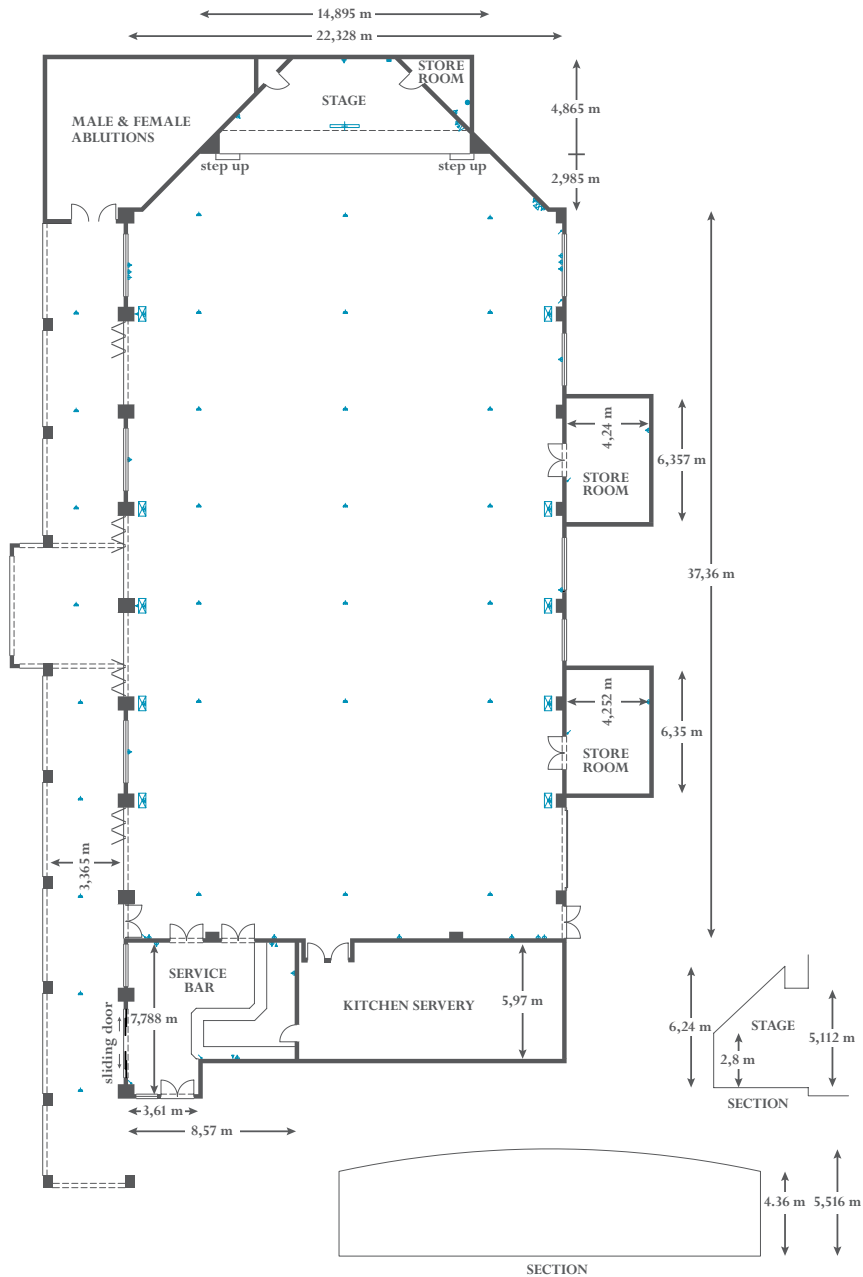

CONFERENCE VENUE: THE SENTINEL

A large thatched conference room facing the peaks of Champagne Castle and Cathkin Peak. Acoustically designed and beautifully decorated to suit the larger conferences.

U-SHAPE	160 delegates
CLASSROOM	700 delegates
CINEMA	1000 delegates
BANQUET	690 delegates



Please refer to Buttress for the key.

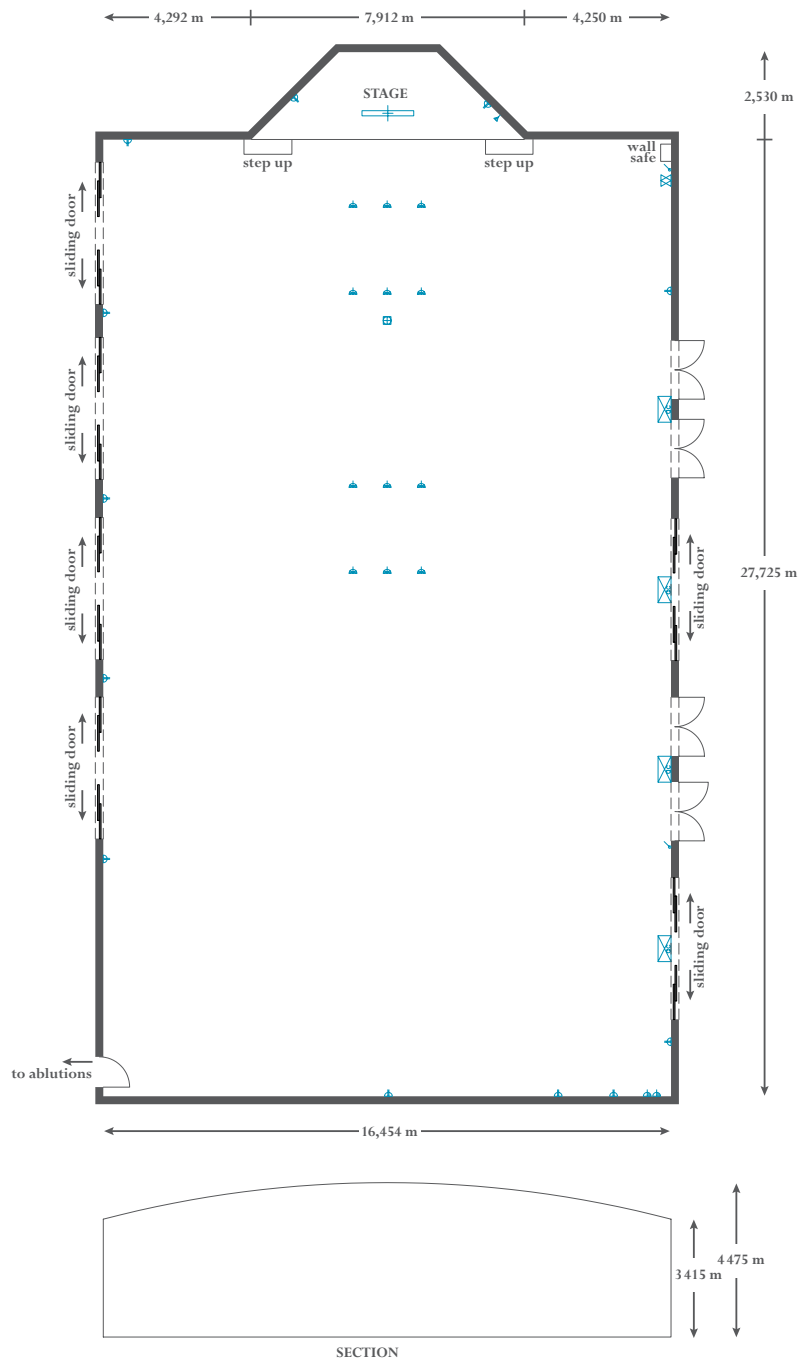

CONFERENCE VENUE: MONKS COWL

A large thatch conference room, acoustically designed and beautifully decorated to suit the larger conferences. Fitted with state of the art conferencing equipment.

U-SHAPE	80 delegates
DOUBLE U-SHAPE	140 delegates
CLASSROOM	380 delegates
HERRINGBONE	200 delegates
BANQUET	300 delegates
CINEMA	550 delegates



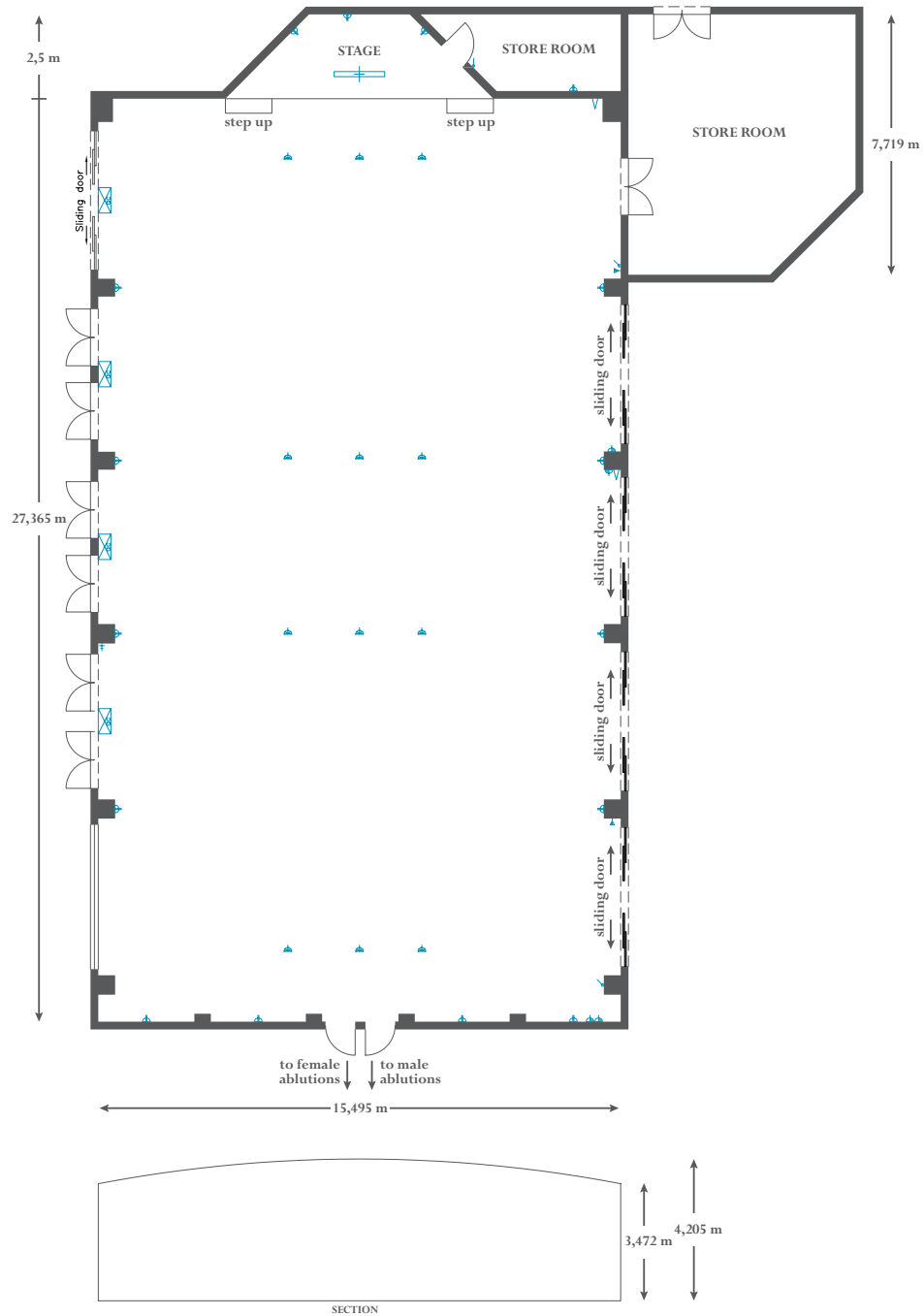

CONFERENCE VENUE: SUMMIT ROOM

Positioned parallel to the Monks Cowl room enables these two venues to be utilised as one venue via folding sliding doors that separate the two rooms.

U-SHAPE	60 delegates
CLASSROOM	300 delegates
BANQUET	250 delegates
CINEMA	400 delegates



Please refer to Buttress for the key.

ADD height section

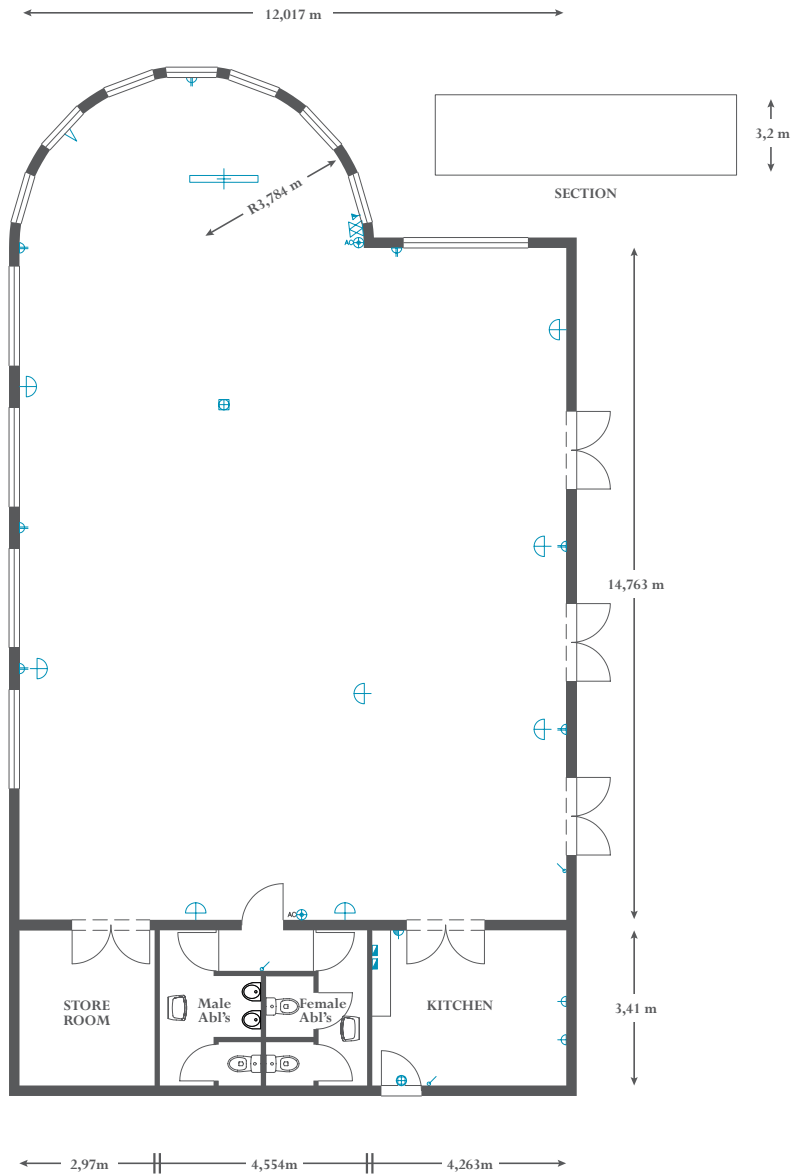

CONFERENCE VENUE: ONDINI CENTRE

A large thatched freestanding conference room in an idyllic garden setting alongside the swimming pool. Beautifully decorated with the added attraction of an extended bay window feature and offering beautiful mountain views through charming cottage pane windows.

U-SHAPE	45 delegates
DOUBLE U-SHAPE	65 delegates
HERRINGBONE	100 delegates
CLASSROOM	120 delegates
CINEMA	150 delegates



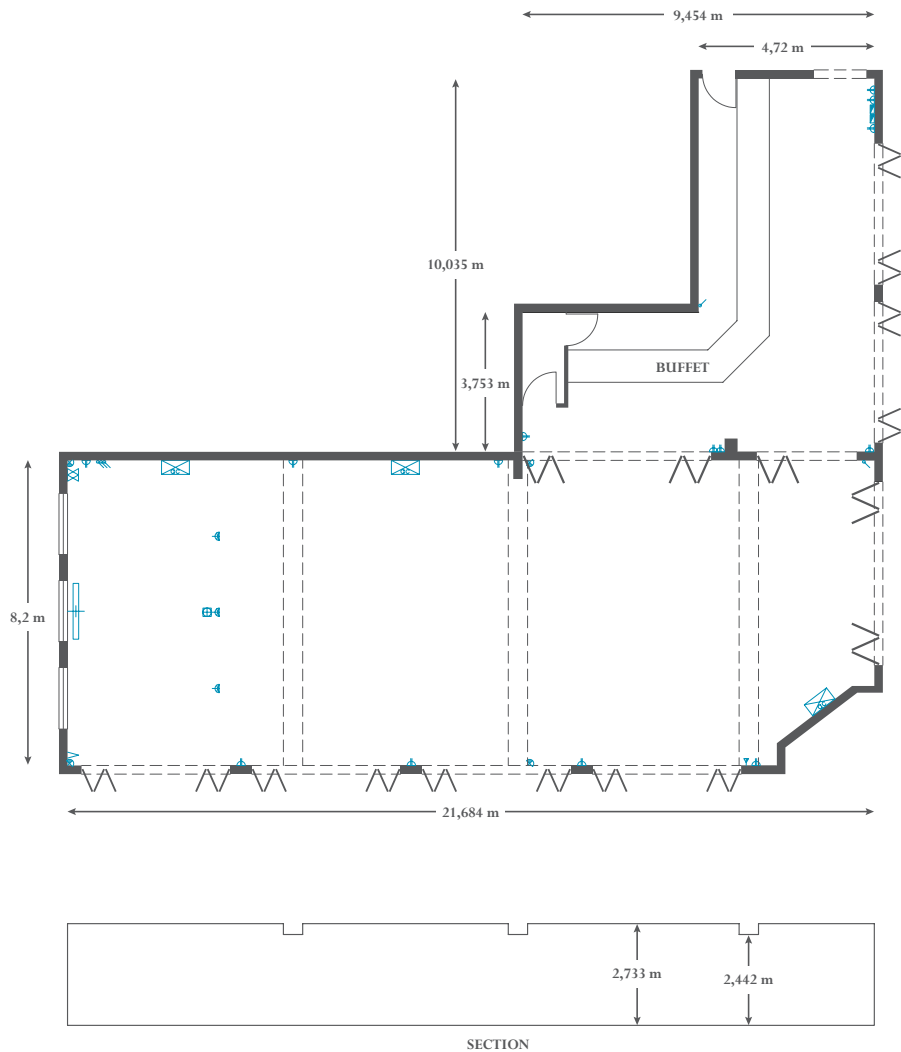

CONFERENCE VENUE: ZUNCKELS

This venue can be serviced directly from a private dining extension buffet or maintain its simplicity as a private fully fitted room which transforms into either a fully functional business venue or a glittering function room for any occasion.

U-SHAPE	40 delegates
CLASSROOM	80 delegates
CINEMA	90 delegates
BANQUET	100 delegates
COCKTAIL PARTY	120 delegates



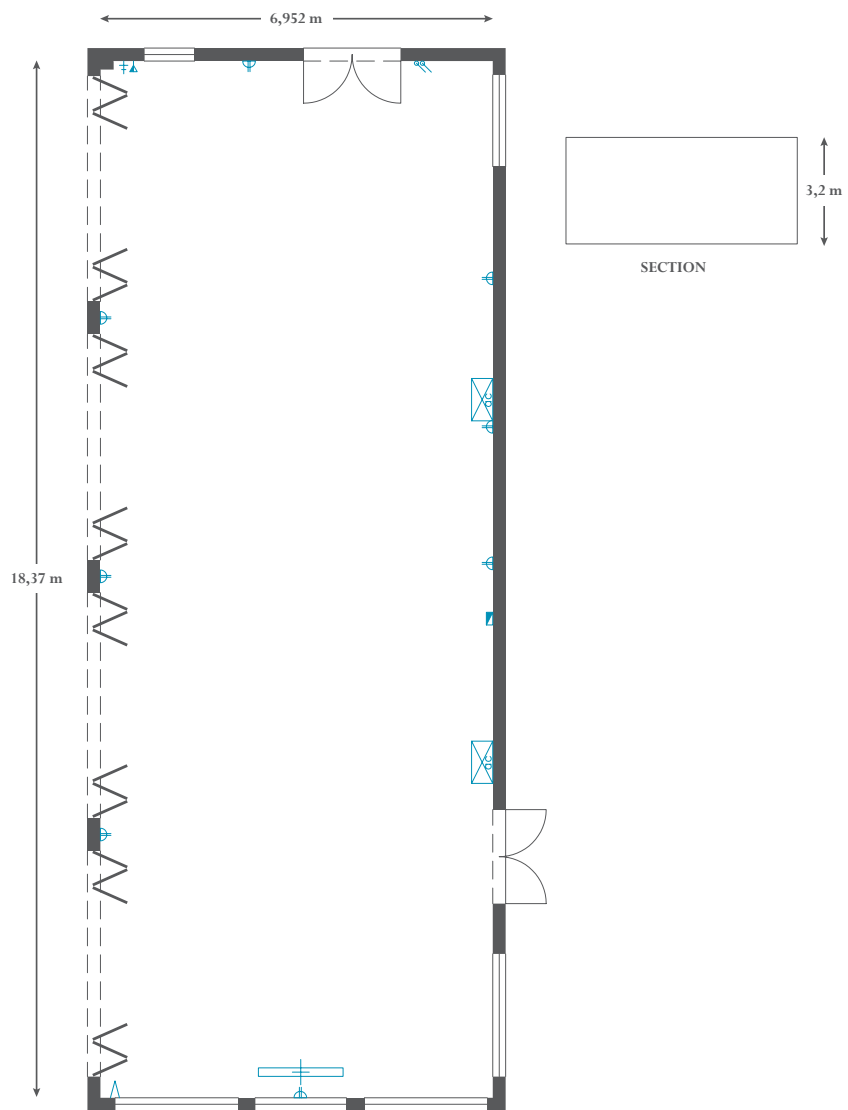

CONFERENCE VENUE: TURRET ROOM

The Turret Room is situated alongside the Zuncfels Conference Room, and should the need arise, can be opened onto Zuncfels through folding sliding doors. The Turret Room has two entrances with the second entrance accessible by vehicle for loading and unloading. This venue can also interlead to the Injasuti Room through a landscaped passageway.

U-SHAPE	35 delegates
CLASSROOM	70 delegates
CINEMA	90 delegates
BANQUET	80 delegates



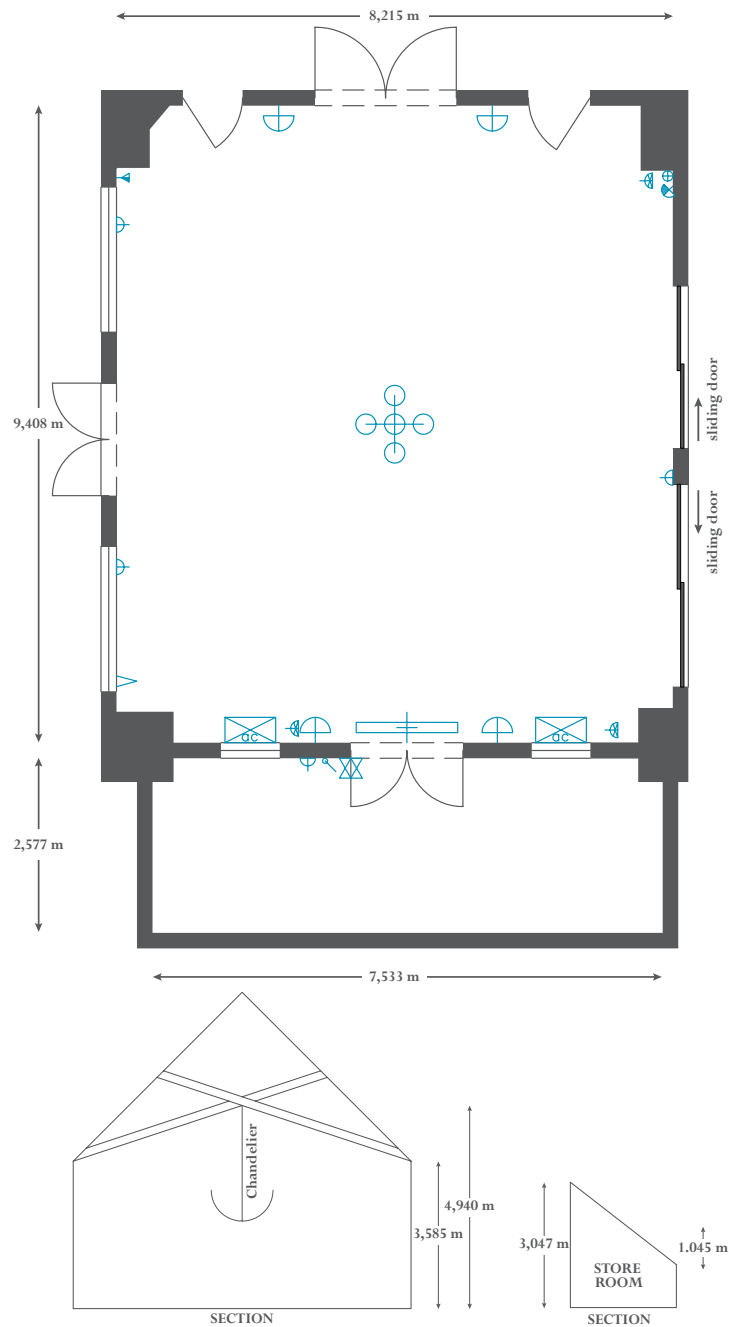

CONFERENCE VENUE: INJASUTI

A charming venue, with cottage pane windows, overlooking a garden. Ideal for a smaller conference or boardroom-style discussions.

U-SHAPE	25 delegates
CLASSROOM	30 delegates
CINEMA	50 delegates
BANQUET	40 delegates



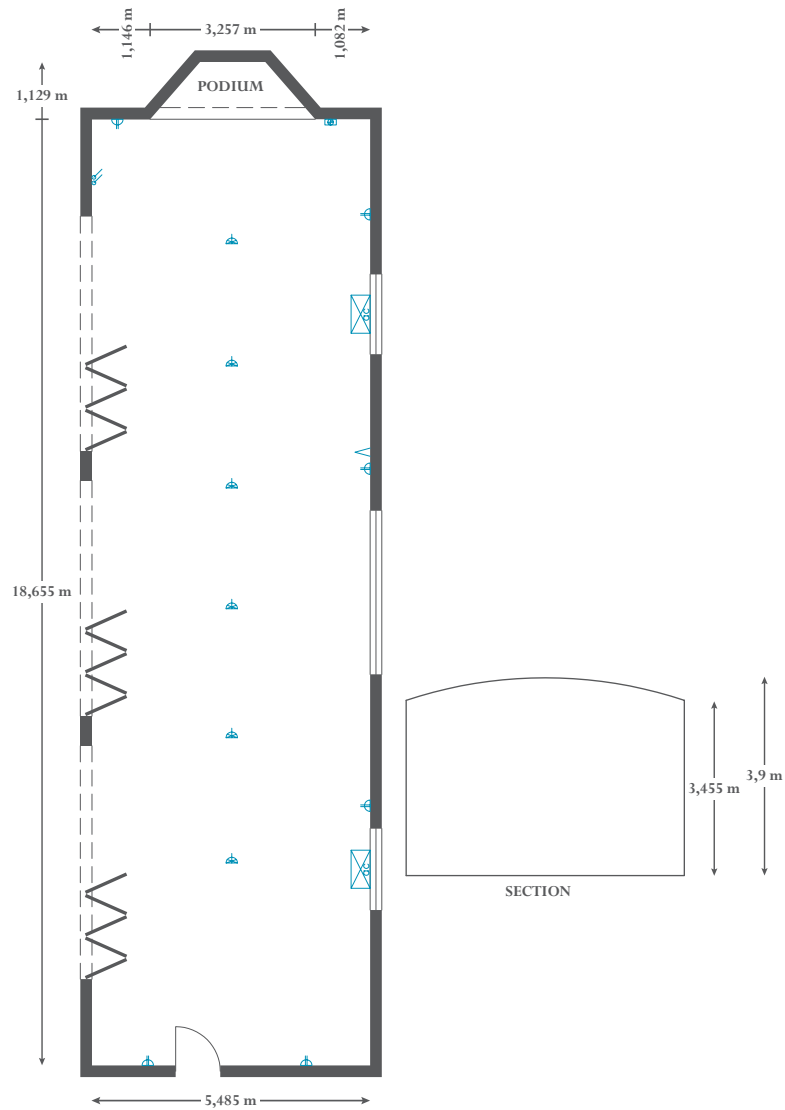

CONFERENCE VENUE: ITHABA

167 m² with natural light. Ideal as a break-away conference room, exhibition space, registration area or buffet room servicing the Monks Cowl, Summit rooms and El Mirador Lounge area.

U-SHAPE	30 delegates
CLASSROOM	80 delegates
CINEMA	110 delegates
BANQUET	50 delegates



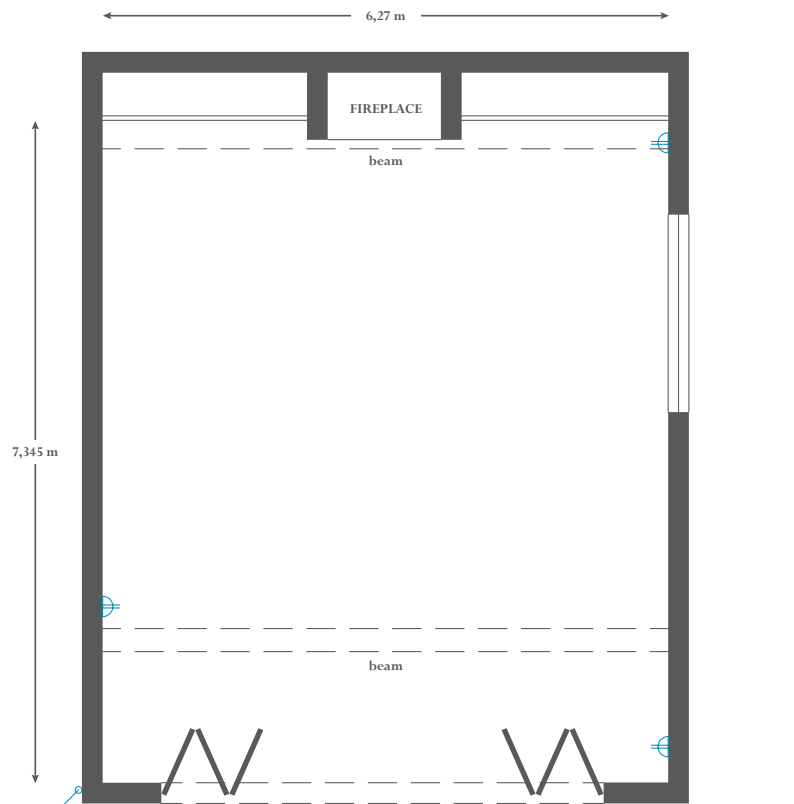

SECTION

Please refer to Buttress for the key.



CONFERENCE VENUE: STERKHORN

This venue can be set up as either a conference room or a comfortable lounge environment for informal meetings.

U-SHAPE	20 delegates
CLASSROOM	30 delegates
CINEMA	40 delegates



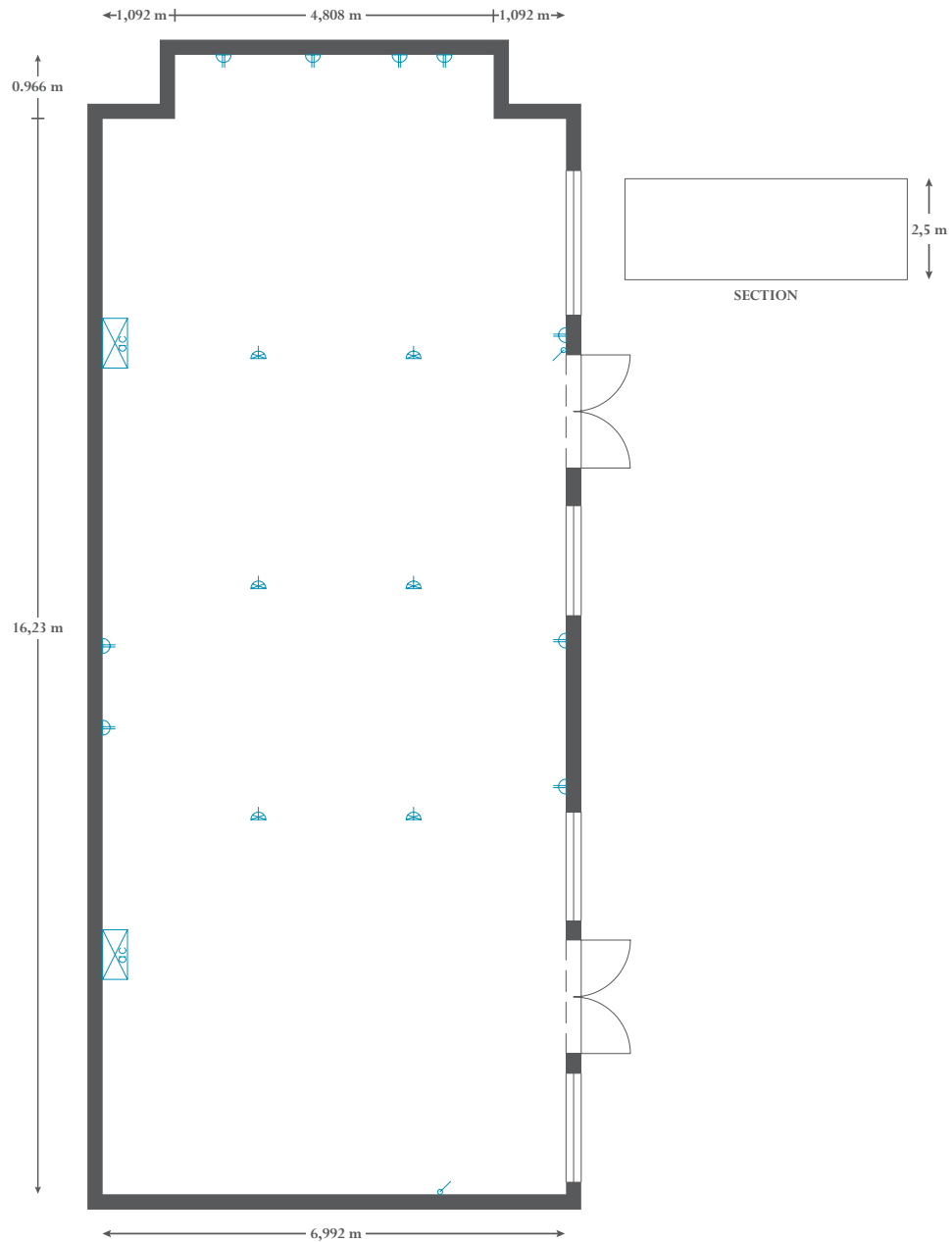

CONFERENCE VENUE: AMPHLETT ROOM

This private secluded and freestanding room opens onto a private hedged garden ideal for smaller conference groups.

U-SHAPE	40 delegates
CLASSROOM	90 delegates
CINEMA	120 delegates
BANQUET	50 delegates





The four boardrooms are positioned adjacent to each other and located upstairs from the main reception foyer. They are equipped with 50-inch LCD wall mounted screens and flip charts. These private and intimate boardrooms are ideal for smaller groups and management and board meetings.

**CONFERENCE VENUE:
BOARDROOM GREYS PASS**

U-SHAPE	15 delegates
CLASSROOM	21 delegates
CINEMA	28 delegates
BANQUET	20 delegates

**CONFERENCE VENUE:
BOARDROOM EASTMANS**

U-SHAPE	15 delegates
CLASSROOM	21 delegates
CINEMA	28 delegates
BANQUET	20 delegates

**CONFERENCE VENUE:
BOARDROOM DRAGONS BACK**

U-SHAPE	15 delegates
CLASSROOM	21 delegates
CINEMA	28 delegates
BANQUET	20 delegates

**CONFERENCE VENUE:
BOARDROOM SHIPS PROW**

U-SHAPE	15 delegates
CLASSROOM	21 delegates
CINEMA	28 delegates
BANQUET	20 delegates





GALA DINNERS

We have a variety of colours to choose from, with cloths from velvet to woven swirled and two tone. Depending on themed colours we can assist best with a direct quote to suit your needs

SANDS OF TIME:

- Stone velvet table cloths with brown taffeta overlay
- Cream chair covers with bronze tie backs
- Gold 4-tier candelabra with floating candles
- Dark cream linen serviettes

FOUR ELEMENTS:

The room is divided into four with quarters draped according to the element and a backdrop for each element:

- FIRE** red table cloths, orange overlays with fairy lights and logs depicting fire, yellow chair covers with orange tie backs
- WATER** blue table cloth, light blue overlay, bowl with floating candles on a mirror with fairy lights, blue chair covers and light blue ties
- EARTH** as per Sands of Time theme
- AIR** white velvet cloths with ice blue organza overlays, candelabra with feathers and crystals, white chair covers with ice blue ties

SEVEN SEAS

- Room fully draped in shades of green and blue
- Round tables with shades of blue and green tablecloths
- Nautical centerpiece
- Life rings on walls
- Dolphins at entrance
- White chair covers

UK PUB EVENING

- The room is fully draped with pub scenes from the UK, alternating with blue, red and white drapes.
- Trestle tables with red/white and blue/white gingham overlays. White table cloths.
- Place settings are pub style – place mats, rolled cutlery in baskets with condiments.
- Bowler hats scattered around – should you require, we can order in hats for the delegates to take home (price on request.)



THEME EVENINGS

IRISH PUB EVENING

- Fully draped room in green and white with a touch of orange
- Trestle tables, white cloths with green/white gingham overlays.
- Place mats with 'Murphy's law', Irish songs or Irish pictures – cutlery rolled in serviettes.
- Backdrops with leprechauns, Irish cottage, Irish scenes, including a green telephone.

MEXICAN FIESTA

- Bright coloured drapes with backdrops depicting dancers, gringos and street vendors.
- Round tables with lime green table cloths and chilli overlays.
- Sombrero and cactus centre pieces.

AFRICAN AFFAIR

- Backdrops that take you into rural Africa, with washer women and chiefs side by side with leopard and elephants.
- Round tables with black table cloths, animal print overlays.
- Grass place mats, animal print paper serviettes.
- Metal guinea fowl centre piece with spear tripods
- Fresh floral arrangements set on wooden slats (additional cost).

WESTERN

- Draped room with backdrops of cattle and horses – no bandits here!
- Trestle tables with white cloths and brown or yellow gingham overlays.
- Tin plates and mugs with oil lamp and western hat as centre piece.
- Tin mugs and plates can be purchased for delegates to take home.



SHEBEEN

- Room draped with backdrops depicting a township shebeen.
- Trestle tables with branded plastic table cloths.
- Wheelbarrows with ice, for quarts (please advise if required).
- Toilet rolls for serviettes
- Cutlery from tins in centre of table.

AROUND THE WORLD

- Each table decorated in a different country, including:
- Africa, England, USA, Ireland, Scotland, Australia, New Zealand, France, Italy, Germany, Mexico, India, Greece.
- Flags hanging from the ceiling and on the walls.

FLOWER POWER

- Bright peace backdrops flanked with brightly coloured drapes
- Coloured round table cloths with contrasting overlays
- Faux flowers and centre pieces
- Clashing chair covers

CRYSTAL ICE

- White drapes with silver strips floor to ceiling around room.
- White table cloths with silver or ice blue overlays.
- Mirrors, floating candles in bowls.
- White chair covers with silver/ice blue tie backs.

IT'S A KIND OF MAGIC

- Room draped in full length black, red and purple drapes with silver strips and "magical" backdrops
- Black table cloths with silver overlays
- Black chair covers with silver tie backs
- Magic centre-piece: top hat, hands, candles, wand
- Mini brooms, stars and wizards' hats hanging from the ceiling

MOULIN ROUGE

- Room draped in full length drapes – burgundy
- Moulin Rouge backdrops
- Round tables with black cloths and red or gold overlays
- Black and red chair covers with gold tie backs
- Feather, mask and candle centre piece

OPTIONAL EXTRAS

Stalls

Can be set up depicting a picnic scene, carnival scene or as different countries

Draped entrance

Entrance to Monks Cowl and Ithaba rooms can be draped to give a different feel to the room

Fairy lights with draped entrance

Fairy Lights

Available for all rooms as well as entrances

Balloons to drop from roof from net (price on request)



The resort offers a variety of superb, serviced accommodation. All rooms are mountain facing fitted with the following: telephone, colour television (three regional channels, M-Net and Movie Magic, Disney and three sports channels), tea/coffee facilities, hairdryer, overhead ceiling fan and bathroom en-suite. Champagne Sports Resort does not offer room service.

HOTEL BEDROOMS:

- Mountain facing double suite with 1 double bed (6)
- Mountain facing executive suite with 1 double bed (3) (bar stocked on request)
- Mountain facing family suites with 1 double bed and 2 single beds (21)
- Mountain facing double/twin suite with 2 single beds (118)
- Mountain facing presidential suite (4) 99 m² luxury king bed. Bars stocked on request.

Total number of rooms: 152

Total number of beds (one person per double bed): 312 (excluding T/S Units)

Wheel chair ramps available.

TIMESHARE UNITS:

Champagne Sports resort has 91 timeshare units. Each unit has a kitchen, dining room and living room area.

- 1 bedroom 1 bathroom units (2)
- 2 bedroom 2 bathroom units (28)
- 3 bedroom 2 bathroom units (3)
- 3 bedroom 3 bathroom units (58)

Total: 91

Timeshare chalets are available for larger groups once all hotel accommodation has been fully occupied. The décor of timeshare and hotel are of the same high standard.

Please note that check-in time is 14h00 and checkout is strictly 10h00 for the hotel. Chalets subject to availability.

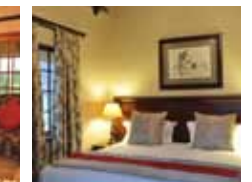
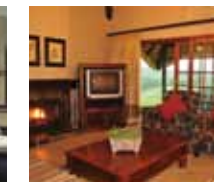

All pricing on theme evenings is available from conference reservations at the resort on 036 468 8000.



Hotel & Timeshare
ACCOMMODATION



PRESIDENTIAL SUITES:

The four presidential suites boasting 99m² of absolute luxury are beautifully positioned with panoramic views of the magnificent Drakensberg mountain range. Fitted with a fully stocked bar, two mounted LCD TV screens, these spacious suites include a large entrance hall, stunning bathroom with heated towel rails, a tastefully decorated lounge with a feature fireplace and an expansive balcony furnished with loungers to relax and take in one of the most beautiful views of a world heritage site.





Hotel & Timeshare
GOLF & LEISURE



Sporting and leisure facilities included in rate, excluding equipment:

5 tennis courts (2 of which are floodlit), table tennis, volleyball, bowls, 5 swimming pools; walks, trampolines, darts, pool tables, basketball, sports-putt and children's play areas.



Champagne Sports Resort boasts a magnificent 18 hole Championship Golf Course nestled in the lush green valleys below the rugged peaks of the Central Drakensberg. Steadily climbing the rankings Champagne Sports Resort has been rated as South Africa's most beautiful golf course. Many years of thought, design and investment have resulted in this incredible final product that golfers travel far and wide to experience. There is something truly unique and special playing golf on one of the most scenic courses in the world with the awe-inspiring presence of the Champagne and Cathkin Peaks towering above you. It is an experience to behold and one we trust all of you will remember and return to enjoy.





Hotel & Timeshare
WELLNESS CENTRE

CHAMPAGNE SPORTS SALON:

Champagne Sports Resort is proud to announce completion of the new salon and gym. Our salon boasts a well balanced range of treatments and products to ensure you leave feeling revitalised and refreshed. Our broad range of treatments and incredible views from the resting area ensure a relaxing upmarket salon experience. The new gym is fully equipped to ensure training options to suit all requirements from general weight training to cardiovascular exercise.

Champagne Sports Salon: 072 611 1767
(all treatments can be viewed in the White Pages at the back of this pack)



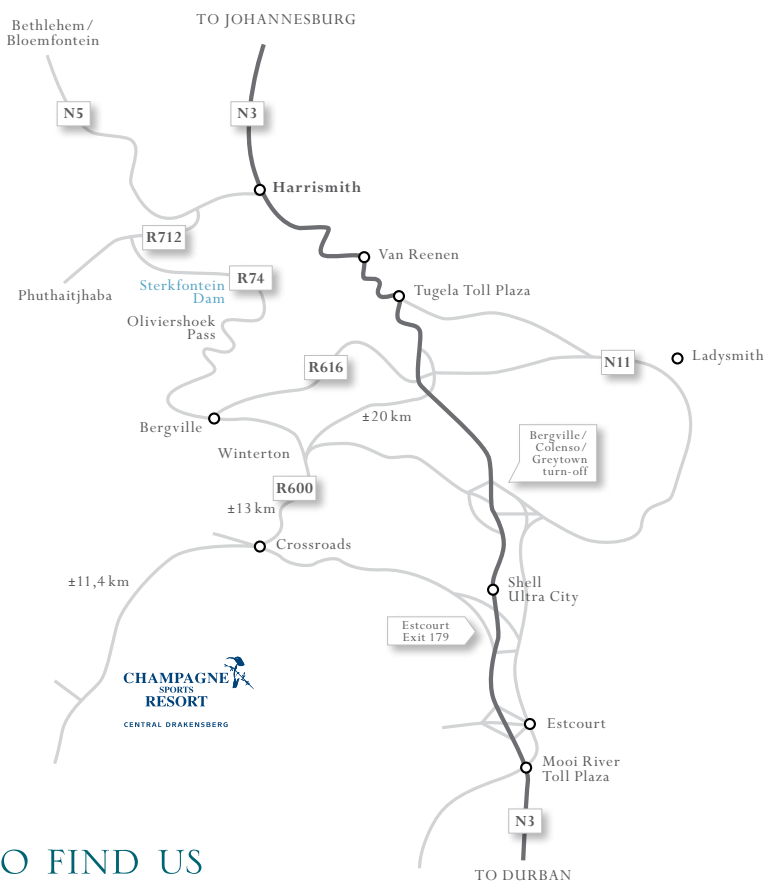

HOW TO FIND US



Freeway route from Durban:

Take N3 past Pietermaritzburg, through Mooi River and past the Wagendrift Dam (on your left). Take Exit 179 (ESTCOURT NORTH) and turn left at the glide-off. Travel 28kms through Loskop (beware of animals on this road) to the crossroads signposted R600 Central Drakensberg. Turn left and drive for ± 11 kms to Champagne Sports on your left.

Scenic route from Johannesburg, suitable ONLY if conditions are not wet or freezing:

Take N3 from Johannesburg to Harrismith then right onto N5 (BETHLEHEM/BLOEMFONTEIN). Turn left onto R712 (QWA-QWA/BERGVILLE) after ± 5 kms, then left again onto R74 (BERGVILLE/OLIVIERSHOEK PASS) after ± 10 kms. Pass Sterkfontein Dam, through Bergville towards Winterton. Once in Winterton, turn right at the crossroads signposted R600 Central Drakensberg (at the Engen garage). Continue ± 13 kms, over the Thokozisa crossroads, then for another ± 11 kms to Champagne Sports on your left. ± 11 kms to Champagne Sports on your left.

Freeway route from Johannesburg:

Take N3 from Johannesburg to Van Reenen's Pass, and through Tugela Plaza at the bottom of the Pass. Travel ± 14 kms to R616 (BERGVILLE) turn, then left onto N11 to Ladysmith. Drive for ± 4 kms before turning right onto R600 (SPIOENKOP/WINTERTON). Go over highway, past Spioenkop Lodge/Nature Reserve to T-junction. Turn left towards Winterton. Once in Winterton, turn right at the crossroads signposted R600 Central Drakensberg (at the Engen garage). Continue ± 13 kms, over the Thokozisa crossroads, then for another ± 11 kms to Champagne Sports on your left.